

Bath & North East Somerset Council		
MEETING:	Licensing (Gambling and Licensing) Committee	AGENDA ITEM NUMBER
MEETING DATE:	Friday 17 December 2010	
TITLE:	Application for a Premises Licence for Richmond Arms , 7 Richmond Place, Beacon Hill, Bath, BA1 5PZ	
WARD:	Lansdown	
AN OPEN PUBLIC ITEM		
List of attachments to this report:		
Annex A Application for a Premises Licence (including plan of premises)		
Annex B Current Premises Licence		
Annex C Site Plan		
Annex D Representation from Environmental Health		
Annex E Representations from Interested Parties		

1 THE ISSUE

- 1.1 An application has been received for a new Premises Licence under the Licensing Act 2003 in respect of **Richmond Arms, 7 Richmond Place, Beacon Hill, Bath, BA1 5PZ (Annex A)**
- 1.2 The premises already benefits from a Premises Licence in respect of the ground floor and external seating area (Annex B).
- 1.3 The new application is to allow for the addition of the first floor to the premises.

2 RECOMMENDATION

- 2.1 That the sub committee determines this application.

3 FINANCIAL IMPLICATIONS

- 3.1 There are no financial implications arising from this report.

4 THE REPORT

- 4.1 An application has been received for a **new** Premises Licence.
- 4.2 The application requests the same activities, hours and conditions as apply under the existing premises licence, which are:

- 1) The **Sale of Alcohol for consumption on and off the premises** between the following hours:

Monday to Thursday 11.00 to 23.00

Friday and Saturday 11.00 to 01.00

Sunday 12.00 to 23.00

Non Standard Timings

An additional hour every Friday, Saturday, Sunday and Monday for each May Bank Holiday, Spring/Whitsun Bank Holiday and every August Bank Holiday weekend.

An additional hours every Thursday, Friday, Saturday, Sunday and Monday for the Easter Bank Holiday weekend.

An additional hour every Christmas Eve and Boxing Day.

From the start of permitted hours on New Year's Eve to the end of permitted hours on New Year's Day.

- 2) The **Provision of Regulated Entertainment** by way of **Live Music** and **Recorded Music (both indoors only)** between the following hours:

Monday to Saturday 11.00 to 23.00

Sunday 12.00 to 22.30

Non Standard Timings

As above.

- 3) The proposed **Opening Hours** are:

Monday to Thursday 11.00 to 23.30

Friday and Saturday 11.00 to 01.30

Sunday 12.00 to 23.30

Non Standard Timings

As above.

- 4) The proposed conditions, as attached to annex 2 and 3 of the current premises licence, are:

- Regulated Entertainment in the form of live music will not take place on more than 12 occasions per year.
- The beer garden will be vacated by 11.00 pm on Mondays to Saturdays and 10.30 pm on Sundays.

- There will be no admission to the premises after 11.00 pm on Mondays to Saturdays and 10.30 pm on Sundays.
- The doors and windows to the premises will be closed after 11.00 pm on Mondays to Saturdays and 10.30 pm on Sundays and in addition, whenever live music takes place.
- Signs will be displayed inside the premises asking customers to leave and disperse quietly.
- Whenever live music is taking place, the premises supervisor will monitor the noise levels from outside the premises.
- No AWP machines on the premises.
- No nudity or strip tease.
- No unaccompanied children allowed on the premises.

4.3 A site plan is attached at Annex C.

4.4 The Licensing Act 2003 (Section 4) states that it is the duty of all Licensing Authorities to carry out their functions under the Act with a view to promoting the licensing objectives. The licensing objectives are:-

- a) The Prevention of Crime and Disorder.
- b) Public Safety.
- c) The Prevention of Public Nuisance, and
- d) The Protection of Children from Harm.

Each objective is of equal importance; there are no other licensing objectives so these four are of paramount consideration at all times. When considering applications/representations/notifications the Licensing Authority will have regard to these licensing objectives.

4.5 The Licensing Authority may grant the application with or without additional conditions.

4.6 The Licensing Authority should also have regard to the Council's Licensing Policy, the Statutory Guidance issued under Section 182 of the Licensing Act 2003, and the Licensing Act itself, and in particular to:-

- a) Paragraphs 3, 5, 6, 9, 10, 15-20, 23, 24, 28, 33-37, 41 to 44 of the policy.
- b) Chapters 8, 9 and 10 of the Statutory Guidance (as revised March 2010).
- c) Sections 4, 9, 10, 11, 12, 13, 16, 17, 18, 23, 182, 183, and Schedule 2 of the Act.

4.7 If the application is refused the applicant may appeal within 21 days of the notification to the Magistrates Court. If the application is granted the person making the relevant representation may appeal within 21 days of the notification to the Magistrates Court.

On appeal the court may either dismiss the appeal; substitute the decision appealed against for any other decision which could have been made by the Licensing Authority, or remit the case to the Licensing Authority to dispose of it in accordance with the direction of the court. The court may make such order for costs as it thinks fit.

- 4.8 In accordance with the requirements of the Act the applicants served copies of the application upon the police, the fire authority, environmental health, development control, trading standards, and the child protection agency.
- 4.9 The applicant is required to place a notice at the premises for a period of 28 days starting the day after the application is made and place an advert in a local newspaper within 10 days of submitting the application to the licensing authority.
- 4.10 A representation has been received from **Environmental Health** in relation to the licensing objective of The Prevention of Public Nuisance. (Annex D) The representation recommends that the first floor area should be used for dining only and should not be licensed for regulated entertainment.
- 4.11 Representations have been received from local residents in relation to the licensing objectives of the Prevention of Crime and Disorder, the Prevention of Public Nuisance, Public Safety and the Protection of Children from Harm. (Annex E)
- 4.12 This report has not been sent to the Trades Union because they would have no involvement.

Contact person	Emma Stoneman, Licensing Officer, 01225 396719
Background papers	Licensing Act 2003, Guidance Notes issued under section 182 of the Licensing Act 2003, Licensing Act 2003 Regulations, B&NES Statement of Licensing Policy.

I certify that I have scanned the original document.
 Signed: *[Signature]*
 Bath & Glens Licensing

ENVIRONMENTAL SERVICES
 ANNEX A #
 22 OCT 2010
 Post Log No: *2115 214756*
 Receipt No: *1234*
 CHICA & FIC

Application for a premises licence to be granted under the Licensing Act 2003

PLEASE READ THE FOLLOWING INSTRUCTIONS FIRST

Before completing this form please read the guidance notes at the end of the form. If you are completing this form by hand please write legibly in block capitals. In all cases ensure that your answers are inside the boxes and written in black ink. Use additional sheets if necessary. You may wish to keep a copy of the completed form for your records.

I/We Punch Taverns Plc
(Insert name(s) of applicant)

apply for a premises licence under section 17 of the Licensing Act 2003 for the premises described in Part 1 below (the premises) and I/we are making this application to you as the relevant licensing authority in accordance with section 12 of the Licensing Act 2003

Part 1 – Premises Details

Postal address of premises or, if none, ordnance survey map reference or description Richmond Arms 7 Richmond Place Beacon Hill			
Post town	Bath	Post code	BA1 5PZ

Telephone number at premises (if any)	
Non-domestic rateable value of premises	£6850

Part 2 - Applicant Details

Please state whether you are applying for a premises licence as
 Please tick yes

- a) an individual or individuals * please complete section (A)
- b) a person other than an individual *
 - i. as a limited company please complete section (B)
 - ii. as a partnership please complete section (B)
 - iii. as an unincorporated association or please complete section (B)
 - iv. other (for example a statutory corporation) please complete section (B)
- c) a recognised club please complete section (B)
- d) a charity please complete section (B)

- e) the proprietor of an educational establishment please complete section (B)
- f) a health service body please complete section (B)
- g) a person who is registered under Part 2 of the Care Standards Act 2000 (c14) in respect of an independent hospital please complete section (B)
- h) the chief officer of police of a police force in England and Wales please complete section (B)

* If you are applying as a person described in (a) or (b) please confirm:

Please tick yes

- I am carrying on or proposing to carry on a business which involves the use of the premises for licensable activities; or
- I am making the application pursuant to a
 - statutory function or
 - a function discharged by virtue of Her Majesty's prerogative

(A) INDIVIDUAL APPLICANTS (fill in as applicable)

Mr <input type="checkbox"/>	Mrs <input type="checkbox"/>	Miss <input type="checkbox"/>	Ms <input type="checkbox"/>	Other Title (for example, Rev)	
Surname			First names		
I am 18 years old or over				<input type="checkbox"/> Please tick yes	
Current postal address if different from premises address					
Post Town				Postcode	
Daytime contact telephone number					
E-mail address (optional)					

SECOND INDIVIDUAL APPLICANT (if applicable)

Mr <input type="checkbox"/>	Mrs <input type="checkbox"/>	Miss <input type="checkbox"/>	Ms <input type="checkbox"/>	Other Title (for example, Rev)	
Surname			First names		
I am 18 years old or over				<input type="checkbox"/> Please tick yes	

Current postal address if different from premises address			
Post Town		Postcode	
Daytime contact telephone number			
E-mail address (optional)			

(B) OTHER APPLICANTS

Please provide name and registered address of applicant in full. Where appropriate please give any registered number. In the case of a partnership or other joint venture (other than a body corporate), please give the name and address of each party concerned.

Name Punch Taverns Plc
Address Jubilee House Second Avenue Burton Upon Trent
Registered number (where applicable) 03752645
Description of applicant (for example, partnership, company, unincorporated association etc.) Company
Telephone number (if any) 01283 501 600
E-mail address (optional)

Part 3 Operating Schedule

When do you want the premises licence to start?

Day	Month	Year
2	2	112010

If you wish the licence to be valid only for a limited period, when do you want it to end?

Day	Month	Year

Please give a general description of the premises (please read guidance note 1)
Public house.

If 5,000 or more people are expected to attend the premises at any one time, please state the number expected to attend.

n/a

What licensable activities do you intend to carry on from the premises?

(Please see sections 1 and 14 of the Licensing Act 2003 and Schedules 1 and 2 to the Licensing Act 2003)

Provision of regulated entertainment

Please tick yes

- | | |
|---|-------------------------------------|
| a) plays (if ticking yes, fill in box A) | <input type="checkbox"/> |
| b) films (if ticking yes, fill in box B) | <input type="checkbox"/> |
| c) indoor sporting events (if ticking yes, fill in box C) | <input type="checkbox"/> |
| d) boxing or wrestling entertainment (if ticking yes, fill in box D) | <input type="checkbox"/> |
| e) live music (if ticking yes, fill in box E) | <input checked="" type="checkbox"/> |
| f) recorded music (if ticking yes, fill in box F) | <input checked="" type="checkbox"/> |
| g) performances of dance (if ticking yes, fill in box G) | <input type="checkbox"/> |
| h) anything of a similar description to that falling within (e), (f) or (g) (if ticking yes, fill in box H) | <input type="checkbox"/> |

Provision of entertainment facilities:

- | | |
|---|--------------------------|
| i) making music (if ticking yes, fill in box I) | <input type="checkbox"/> |
| j) dancing (if ticking yes, fill in box J) | <input type="checkbox"/> |
| k) entertainment of a similar description to that falling within (i) or (j) (if ticking yes, fill in box K) | <input type="checkbox"/> |

Provision of late night refreshment (if ticking yes, fill in box L)

Supply of alcohol (if ticking yes, fill in box M)

In all cases complete boxes N, O and P

A

Plays Standard days and timings (please read guidance note 6)			Will the performance of a play take place indoors or outdoors or both – please tick (please read guidance note 2)	Indoors	<input type="checkbox"/>
Day	Start	Finish		Outdoors	<input type="checkbox"/>
Mon			Please give further details here (please read guidance note 3)		
Tue					
Wed			State any seasonal variations for performing plays (please read guidance note 4)		
Thur					
Fri			Non standard timings. Where you intend to use the premises for the performance of plays at different times to those listed in the column on the left, please list (please read guidance note 5)		
Sat					
Sun					

B

Films Standard days and timings (please read guidance note 6)			Will the exhibition of films take place indoors or outdoors or both – please tick (please read guidance note 2)	Indoors	<input type="checkbox"/>
				Outdoors	<input type="checkbox"/>
Day	Start	Finish		Both	<input type="checkbox"/>
Mon			Please give further details here (please read guidance note 3)		
Tue					
Wed			State any seasonal variations for the exhibition of films (please read guidance note 4)		
Thur					
Fri			Non standard timings. Where you intend to use the premises for the exhibition of films at different times to those listed in the column on the left, please list (please read guidance note 5)		
Sat					
Sun					

C

Indoor sporting events Standard days and timings (please read guidance note 6)			<u>Please give further details</u> (please read guidance note 3)
Day	Start	Finish	
Mon			
Tue			<u>State any seasonal variations for indoor sporting events</u> (please read guidance note 4).
Wed			
Thur			<u>Non standard timings. Where you intend to use the premises for indoor sporting events at different times to those listed in the column on the left, please list</u> (please read guidance note 5)
Fri			
Sat			
Sun			

D

Boxing or wrestling entertainments Standard days and timings (please read guidance note 6)			Indoors <input type="checkbox"/>	Outdoors <input type="checkbox"/>	Both <input type="checkbox"/>
Day	Start	Finish			
			Will the boxing or wrestling entertainment take place indoors or outdoors or both – please tick (please read guidance note 2)		
Mon			Please give further details here (please read guidance note 3)		
Tue					
Wed					
Thur			State any seasonal variations for boxing or wrestling entertainment (please read guidance note 4)		
Fri			Non standard timings. Where you intend to use the premises for boxing or wrestling entertainment at different times to those listed in the column on the left, please list (please read guidance note 5)		
Sat					
Sun					

E

Live music Standard days and timings (please read guidance note 6)			<u>Will the performance of live music take place indoors or outdoors or both – please tick</u> (please read guidance note 2)	Indoors	<input checked="" type="checkbox"/>		
Day				Start	Finish	Outdoors	<input type="checkbox"/>
						Both	<input type="checkbox"/>
Mon	11:00	23:00		<u>Please give further details here</u> (please read guidance note 3) Amplified and unamplified music.			
Tue	11:00	23:00					
Wed	11:00	23:00	<u>State any seasonal variations for the performance of live music</u> (please read guidance note 4)				
Thur	11:00	23:00					
Fri	11:00	23:00	<u>Non standard timings. Where you intend to use the premises for the performance of live music at different times to those listed in the column on the left, please list</u> (please read guidance note 5)				
Sat	11:00	23:00	An additional hour every Friday, Saturday, Sunday and Monday for each May Bank Holiday, Spring/Whitsun Bank Holiday and every August Bank Holiday Weekend.				
Sun	12:00	22:30	An additional hour every Thursday, Friday, Saturday, Sunday and Monday for the Easter Bank Holiday Weekend. An additional hour every Christmas Eve and Boxing Day. From the start of permitted hours on New Years Eve to the end of permitted hours on New Years Day.				

F

Recorded music Standard days and timings (please read guidance note 6)			Will the playing of recorded music take place indoors or outdoors or both – please tick (please read guidance note 2)	Indoors	<input checked="" type="checkbox"/>
				Outdoors	<input type="checkbox"/>
				Both	<input type="checkbox"/>
Day	Start	Finish	Please give further details here (please read guidance note 3) Recorded music played inside the premises.		
Mon	11:00	23:00			
Tue	11:00	23:00	State any seasonal variations for the playing of recorded music (please read guidance note 4)		
Wed	11:00	23:00			
Thur	11:00	23:00	Non standard timings. Where you intend to use the premises for the playing of recorded music at different times to those listed in the column on the left, please list (please read guidance note 5) An additional hour every Friday, Saturday, Sunday and Monday for each May Bank Holiday, Spring/Whitsun Bank Holiday and every August Bank Holiday Weekend. An additional hour every Thursday, Friday, Saturday, Sunday and Monday for the Easter Bank Holiday Weekend. An additional hour every Christmas Eve and Boxing Day. From the start of permitted hours on New Years Eve to the end of permitted hours on New Years Day..		
Fri	11:00	23:00			
Sat	11:00	23:00			
Sun	12:00	22:30			

G

Performances of dance Standard days and timings (please read guidance note 6)			Will the performance of dance take place indoors or outdoors or both – please tick (please read guidance note 2)	Indoors	<input type="checkbox"/>
Day	Start	Finish		Outdoors	<input type="checkbox"/>
Mon			Please give further details here (please read guidance note 3)		
Tue					
Wed			State any seasonal variations for the performance of dance (please read guidance note 4)		
Thur					
Fri			Non standard timings. Where you intend to use the premises for the performance of dance at different times to those listed in the column on the left, please list (please read guidance note 5)		
Sat					
Sun					

H

Anything of a similar description to that falling within (e), (f) or (g) Standard days and timings (please read guidance note 6)			<u>Please give a description of the type of entertainment you will be providing</u>	
Day	Start	Finish	<u>Will this entertainment take place indoors or outdoors or both – please tick</u> (please read guidance note 2)	Indoors <input type="checkbox"/>
Mon				Outdoors <input type="checkbox"/>
				Both <input type="checkbox"/>
Tue			<u>Please give further details here</u> (please read guidance note 3)	
Wed				
Thur			<u>State any seasonal variations for entertainment of a similar description to that falling within (e), (f) or (g)</u> (please read guidance note 4)	
Fri				
Sat			<u>Non standard timings. Where you intend to use the premises for the entertainment of a similar description to that falling within (e), (f) or (g) at different times to those listed in the column on the left, please list</u> (please read guidance note 5)	
Sun				

Provision of facilities for making music Standard days and timings (please read guidance note 6)			Please give a description of the facilities for making music you will be providing	
			Will the facilities for making music be indoors or outdoors or both – please tick (please read guidance note 2)	
Day	Start	Finish	Indoors	<input type="checkbox"/>
			Outdoors	<input type="checkbox"/>
			Both	<input type="checkbox"/>
Mon			Please give further details here (please read guidance note 3)	
Tue			State any seasonal variations for the provision of facilities for making music (please read guidance note 4)	
Wed			Non standard timings. Where you intend to use the premises for provision of facilities for making music at different times to those listed in the column on the left, please list (please read guidance note 5)	
Thur				
Fri				
Sat				
Sun				

J

Provision of facilities for dancing Standard days and timings (please read guidance note 6)			Will the facilities for dancing be indoors or outdoors or both – please tick (see guidance note 2)	Indoors	<input type="checkbox"/>
				Outdoors	<input type="checkbox"/>
				Both	<input type="checkbox"/>
			<u>Please give a description of the facilities for dancing you will be providing</u>		
Day	Start	Finish			
Mon			<u>Please give further details here</u> (please read guidance note 3)		
Tue					
Wed			<u>State any seasonal variations for providing dancing facilities</u> (please read guidance note 4)		
Thur					
Fri			<u>Non standard timings. Where you intend to use the premises for the provision of facilities for dancing entertainment at different times to those listed in the column on the left, please list</u> (please read guidance note 5)		
Sat					
Sun					

K

Provision of facilities for entertainment of a similar description to that falling within i or j Standard days and timings (please read guidance note 6)			<u>Please give a description of the type of entertainment facility you will be providing</u>		
Day	Start	Finish	<u>Will the entertainment facility be indoors or outdoors or both – please tick</u> (please read guidance note 2)	Indoors	<input type="checkbox"/>
Mon				Outdoors	<input type="checkbox"/>
				Both	<input type="checkbox"/>
Tue			<u>Please give further details here</u> (please read guidance note 3)		
Wed					
Thur					
Fri			<u>State any seasonal variations for the provision of facilities for entertainment of a similar description to that falling within i or j</u> (please read guidance note 4)		
Sat					
Sun					
			<u>Non standard timings. Where you intend to use the premises for the provision of facilities for entertainment of a similar description to that falling within i or j at different times to those listed in the column on the left, please list</u> (please read guidance note 5)		

L

Late night refreshment Standard days and timings (please read guidance note 6)			Will the provision of late night refreshment take place indoors or outdoors or both – please tick (please read guidance note 2)	Indoors	<input type="checkbox"/>
Day	Start	Finish		Outdoors	<input type="checkbox"/>
Mon			<u>Please give further details here</u> (please read guidance note 3)	Both	<input type="checkbox"/>
Tue					
Wed			<u>State any seasonal variations for the provision of late night refreshment</u> (please read guidance note 4)		
Thur					
Fri			<u>Non standard timings. Where you intend to use the premises for the provision of late night refreshment at different times, to those listed in the column on the left, please list</u> (please read guidance note 5)		
Sat					
Sun					

M

Supply of alcohol Standard days and timings (please read guidance note 6)			Will the supply of alcohol be for consumption (Please tick box) (please read guidance note 7)	On the premises	<input type="checkbox"/>
				Off the premises	<input type="checkbox"/>
				Both	<input checked="" type="checkbox"/>
Day	Start	Finish	State any seasonal variations for the supply of alcohol (please read guidance note 4)		
Mon	11:00	23:00			
Tue	11:00	23:00			
Wed	11:00	23:00			
Thur	11:00	23:00			
Fri	11:00				
Sat		01:00			
			Non standard timings. Where you intend to use the premises for the supply of alcohol at different times to those listed in the column on the left, please list (please read guidance note 5)		
			An additional hour every Friday, Saturday, Sunday and Monday for each May Bank Holiday, Spring/Whitsun Bank Holiday and every August Bank Holiday Weekend.		
			An additional hour every Thursday, Friday, Saturday, Sunday and Monday for the Easter Bank Holiday Weekend.		
			An additional hour every Christmas Eve and Boxing Day.		
			From the start of permitted hours on New Years Eve to the end of permitted hours on New Years Day.		
Sun		01:00			
	12:00	23:00			

State the name and details of the individual whom you wish to specify on the licence as premises supervisor

Name Syliva Mizel	
Address 18 St James' Square Lansdowne Bath	
Postcode	BS1 2TS
Personal Licence number (if known) 09/02908/LAPER	
Issuing licensing authority (if known) Bath & North East Somerset Council	

N

Please highlight any adult entertainment or services, activities, other entertainment or matters ancillary to the use of the premises that may give rise to concern in respect of children (please read guidance note 8)

None.

O

Hours premises are open to the public Standard days and timings (please read guidance note 6)			State any seasonal variations (please read guidance note 4)
Day	Start	Finish	
Mon	11:00	23:30	
Tue	11:00	23:30	
Wed	11:00	23:30	
Thur	11:00	23:30	<p>Non standard timings. Where you intend the premises to be open to the public at different times from those listed in the column on the left, please list (please read guidance note 5)</p> <p>An additional hour every Friday, Saturday, Sunday and Monday for each May Bank Holiday, Spring/Whitsun Bank Holiday and every August Bank Holiday Weekend.</p> <p>An additional hour every Thursday, Friday, Saturday, Sunday and Monday for the Easter Bank Holiday Weekend.</p> <p>An additional hour every Christmas Eve and Boxing Day.</p> <p>From the start of permitted hours on New Years Eve to the end of permitted hours on New Years Day..</p>
Fri	11:00		
Sat		01:30	
	11:00		
Sun		01:30	
	12:00	23:30	

Annex 2 – Conditions consistent with the Operating Schedule

No AWP machines on the premises.

No nudity or strip tease.

No unaccompanied children allowed on the premises.

Annex 3 – Conditions attached after a hearing by the licensing authority

The Sub Committee has decided to grant the application to convert and vary the current Justices On Licence under section 35 of the Licensing Act 2003 subject to the following conditions, namely:

Subject to the Mandatory Conditions under Sections 19 and 21 of the Licensing Act 2003.

Subject also to the additional conditions as specified in the operating schedule and those offered by the applicants as stated above.

Supply and sale of alcohol:

Monday to Thursday	11.00 to 23.00
Friday and Saturday	11:00 to 01.00
Sunday	12.00 to 23.00
Regulated Entertainment	
Monday to Thursday	11.00 to 23.00
Friday and Saturday	11.00 to 23.00
Sunday	12.00 to 22.30
Opening Times	
Monday to Thursday	11.00 to 23.30
Friday and Saturday	11.00 to 01.30
Sunday	12.00 to 23.30

The above timings are subject to the seasonal variations and non-standard times as set out in the Applicant's Operating Schedule.

Regulated Entertainment in the form of live music will not take place on more than 12 occasions per year.

The beer garden will be vacated by 11.00pm on Mondays to Saturdays and 10.30pm on Sundays.

There will be no admission to the premises after 11.00pm on Monday to Saturdays and 10.30pm on Sundays.

The doors and windows to the premises will be closed after 11.00pm on Mondays to Saturdays and 10.30pm on Sundays and in addition, whenever live music takes place.

Signs will be displayed inside the premises asking customers to leave and disperse quietly.

Whenever live music is taking place, the premises supervisor will monitor the noise levels from outside the premises.

P Describe the steps you intend to take to promote the four licensing objectives:

a) General – all four licensing objectives (b,c,d,e) (please read guidance note 9)

As per conditions attached to existing premises licence 09/03805/LAPRE attached.

A 30 minute drinking up time on top of the last permitted sale of alcohol to allow customers to use the toilet facilities and disperse from the premises.

Locations of fire safety and other safety equipment subject to change in accordance with the requirements of the responsible authorities or following a risk assessment.

Any detail shown on the plan that is not required by the licensing plans regulations is indicative only and subject to change at any time

b) The prevention of crime and disorder

c) Public safety

d) The prevention of public nuisance

e) The protection of children from harm

--

Please tick yes

- I have made or enclosed payment of the fee
- I have enclosed the plan of the premises
- I have sent copies of this application and the plan to responsible authorities and others where applicable
- I have enclosed the consent form completed by the individual I wish to be premises supervisor, if applicable
- I understand that I must now advertise my application
- I understand that if I do not comply with the above requirements my application will be rejected

IT IS AN OFFENCE, LIABLE ON CONVICTION TO A FINE UP TO LEVEL 5 ON THE STANDARD SCALE, UNDER SECTION 158 OF THE LICENSING ACT 2003 TO MAKE A FALSE STATEMENT IN OR IN CONNECTION WITH THIS APPLICATION

Part 4 – Signatures (please read guidance note 10)

Signature of applicant or applicant's solicitor or other duly authorised agent (See guidance note 11). **If signing on behalf of the applicant please state in what capacity.**

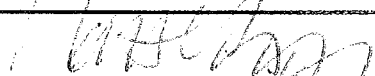
Signature	
Date	15.10.10
Capacity	Solicitor to applicant

For joint applications signature of 2nd applicant or 2nd applicant's solicitor or other authorised agent. (please read guidance note 12). **If signing on behalf of the applicant please state in what capacity.**

Signature	
Date	
Capacity	

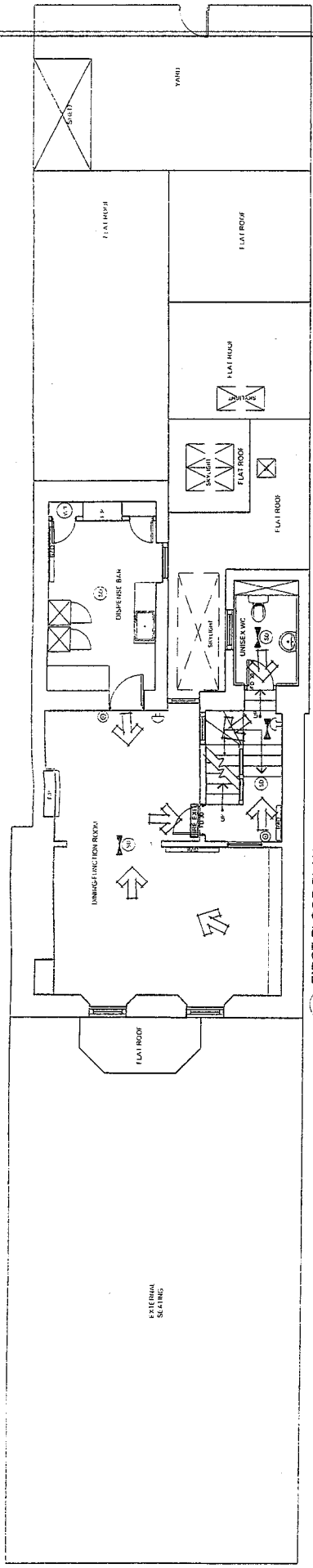

FIRST FLOOR PLAN
SCALE 1:100

FIRE SAFETY KEY	
①	SMOKE DETECTOR
②	HEAT DETECTOR
③	FIRE ALARM CONTROL POINT
④	FIRE ALARM CONTROL POINT
⑤	FIRE ALARM CONTROL POINT
⑥	FIRE ALARM CONTROL POINT
⑦	FIRE ALARM CONTROL POINT
⑧	FIRE ALARM CONTROL POINT
⑨	FIRE ALARM CONTROL POINT
⑩	FIRE ALARM CONTROL POINT
⑪	FIRE ALARM CONTROL POINT
⑫	FIRE ALARM CONTROL POINT
⑬	FIRE ALARM CONTROL POINT
⑭	FIRE ALARM CONTROL POINT
⑮	FIRE ALARM CONTROL POINT
⑯	FIRE ALARM CONTROL POINT
⑰	FIRE ALARM CONTROL POINT
⑱	FIRE ALARM CONTROL POINT
⑲	FIRE ALARM CONTROL POINT
⑳	FIRE ALARM CONTROL POINT
㉑	FIRE ALARM CONTROL POINT
㉒	FIRE ALARM CONTROL POINT
㉓	FIRE ALARM CONTROL POINT
㉔	FIRE ALARM CONTROL POINT
㉕	FIRE ALARM CONTROL POINT
㉖	FIRE ALARM CONTROL POINT
㉗	FIRE ALARM CONTROL POINT
㉘	FIRE ALARM CONTROL POINT
㉙	FIRE ALARM CONTROL POINT
㉚	FIRE ALARM CONTROL POINT
㉛	FIRE ALARM CONTROL POINT
㉜	FIRE ALARM CONTROL POINT
㉝	FIRE ALARM CONTROL POINT
㉞	FIRE ALARM CONTROL POINT
㉟	FIRE ALARM CONTROL POINT
㊱	FIRE ALARM CONTROL POINT
㊲	FIRE ALARM CONTROL POINT
㊳	FIRE ALARM CONTROL POINT
㊴	FIRE ALARM CONTROL POINT
㊵	FIRE ALARM CONTROL POINT
㊶	FIRE ALARM CONTROL POINT
㊷	FIRE ALARM CONTROL POINT
㊸	FIRE ALARM CONTROL POINT
㊹	FIRE ALARM CONTROL POINT
㊺	FIRE ALARM CONTROL POINT
㊻	FIRE ALARM CONTROL POINT
㊼	FIRE ALARM CONTROL POINT
㊽	FIRE ALARM CONTROL POINT
㊾	FIRE ALARM CONTROL POINT
㊿	FIRE ALARM CONTROL POINT

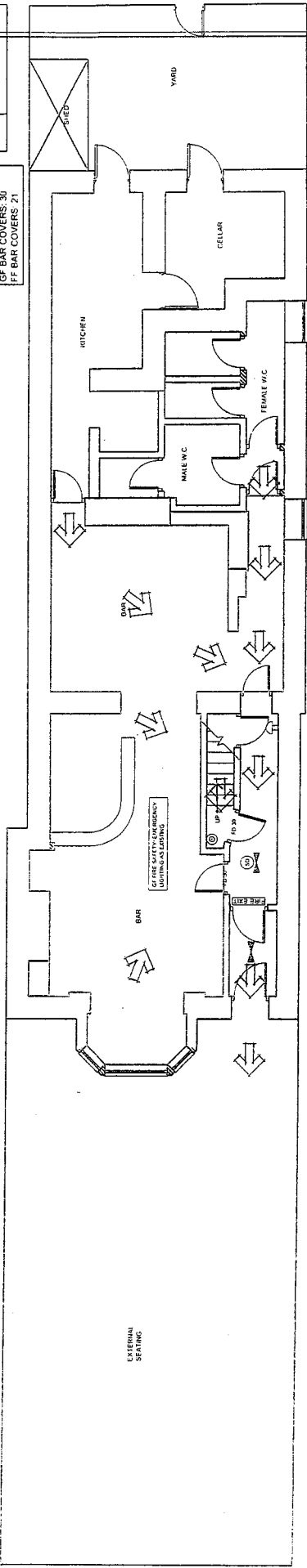

GROUND FLOOR PLAN
SCALE 1:100

Client
PUNCH TAVERNS
7 RICHMOND PLACE
BATH
BA1 5PZ

Job Title
RICHMOND ARMS
Drawing Title
LICENSING PLAN

Date
16.08.10
Drawn By
EE
Scale
A3 @ 1:100

Dwg. No.
PT120.10.L01
Rev.
*

focus design Ltd
15A Parchment Street Winchester
Hants, SO23 8AZ
Tel 01962 85 00 00
Fax 01962 85 00 11



Schedule 12
Part A

Regulation 33, 34

Premises Licence

Premises Licence Number	09/03805/LAPRE
--------------------------------	----------------

Part 1 – Premises Details

Postal address of premises, or if none, ordnance survey map reference or description, including Post Town, Post Code
Richmond Arms Public House 7 Richmond Place Beacon Hill Bath, BA1 5PZ

Telephone number	01283 501600
-------------------------	--------------

Where the licence is time limited the dates	Not applicable
--	----------------

Licensable activities authorised by the licence and the times the licence authorises the carrying out of licensable activities
Sale of Alcohol
Monday to Thursday 11:00 - 23:00
Friday and Saturday 11:00 - 01:00
Sunday 12:00 - 23:00
Performance of Live Music (Indoors only)
Monday to Saturday 11:00 - 23:00
Sunday 12:00 - 22:30
Performance of Recorded Music (Indoors only)
Monday to Saturday 11:00 - 23:00
Sunday 12:00 - 22:30
Non standard timings:
A further additional hour into the morning following every Friday, Saturday, Sunday and Monday for each May Bank Holiday, Spring/Whitsun Bank Holiday and every August Bank Holiday Weekend.
A further additional hour into the morning following every Thursday, Friday, Saturday, Sunday and Monday for the Easter Bank Holiday Weekend
A further additional hour every Christmas Eve and Boxing Day.
From normal activity start time on New Year's Eve until normal activity finish time on New Year's Day.

The opening hours of the premises

Monday to Thursday	11:00 - 23:30
Friday and Saturday	11:00 - 01:30
Sunday	12:00 - 23:30

A further additional hour into the morning following every Friday, Saturday, Sunday and Monday for each May Bank Holiday, Spring/Whitsun Bank Holiday and every August Bank Holiday weekend.

A further additional hour into the morning following every Thursday, Friday, Saturday, Sunday and Monday for the Easter Bank Holiday weekend

A further additional hour every Christmas Eve and Boxing Day

From normal opening time on New Year's Eve until normal closing time on New Year's Day.

Where the licence authorises supplies of alcohol whether these are on and/or off supplies

Alcohol is supplied for consumption both on and off the premises

Part 2

Name, (registered) address, telephone number and email (where relevant) of holder of premises licence

Punch Taverns Plc
Jubilee House
Burton Upon Trent
Staffordshire
DE14 2WF
01225 316725

Registered number of holder, for example company number, charity number (where applicable)

Registered Business Number - Not Applicable

Name, address and telephone number of designated premises supervisor where the premises licence authorises for the supply of alcohol

Ms Sylvia Mizel
18 St James's Square
Lansdown
Bath
BA1 2TS

Personal licence number and issuing authority of personal licence held by designated premises supervisor where the premises licence authorises for the supply of alcohol

09/02908/LAPER
Bath & North East Somerset Council

This licence is issued by Bath & North East Somerset Council as licensing authority under Part 3 of the Licensing Act 2003 and regulations made thereunder.

Signed for and on behalf of
Bath & North East Somerset Council:

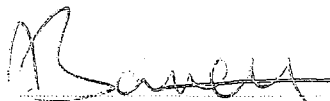

Dated 12 November 2009

Annex 1 – Mandatory conditions

Any individual employed to carry out a security activity must be licensed by the Security Industry Authority.

No supply of alcohol may be made under the premises licence:

- a) at a time when there is no designated premises supervisor in respect of the premises licence, or
- b) at a time when the designated premises supervisor does not hold a personal licence or his personal licence is suspended.

Every supply of alcohol under the premises licence must be made or authorised by a person who holds a personal licence.

Annex 2 – Conditions consistent with the Operating Schedule

No AWP machines on the premises.

No nudity or strip tease.

No unaccompanied children allowed on the premises.

Annex 3 – Conditions attached after a hearing by the licensing authority

The Sub Committee has decided to grant the application to convert and vary the current Justices On Licence under section 35 of the Licensing Act 2003 subject to the following conditions, namely:

Subject to the Mandatory Conditions under Sections 19 and 21 of the Licensing Act 2003.

Subject also to the additional conditions as specified in the operating schedule and those offered by the applicants as stated above.

Supply and sale of alcohol:

Monday to Thursday	11.00 to 23.00
Friday and Saturday	11.00 to 01.00
Sunday	12.00 to 23.00
Regulated Entertainment	
Monday to Thursday	11.00 to 23.00
Friday and Saturday	11.00 to 23.00
Sunday	12.00 to 22.30
Opening Times	
Monday to Thursday	11.00 to 23.30
Friday and Saturday	11.00 to 01.30
Sunday	12.00 to 23.30

The above timings are subject to the seasonal variations and non-standard times as set out in the Applicant's Operating Schedule.

Regulated Entertainment in the form of live music will not take place on more than 12 occasions per year.

The beer garden will be vacated by 11.00pm on Mondays to Saturdays and 10.30pm on Sundays.

There will be no admission to the premises after 11.00pm on Monday to Saturdays and 10.30pm on Sundays.

The doors and windows to the premises will be closed after 11.00pm on Mondays to Saturdays and 10.30pm on Sundays and in addition, whenever live music takes place.

Signs will be displayed inside the premises asking customers to leave and disperse quietly.

Whenever live music is taking place, the premises supervisor will monitor the noise levels from outside the premises.

Annex 4 – Plans

As submitted with application.

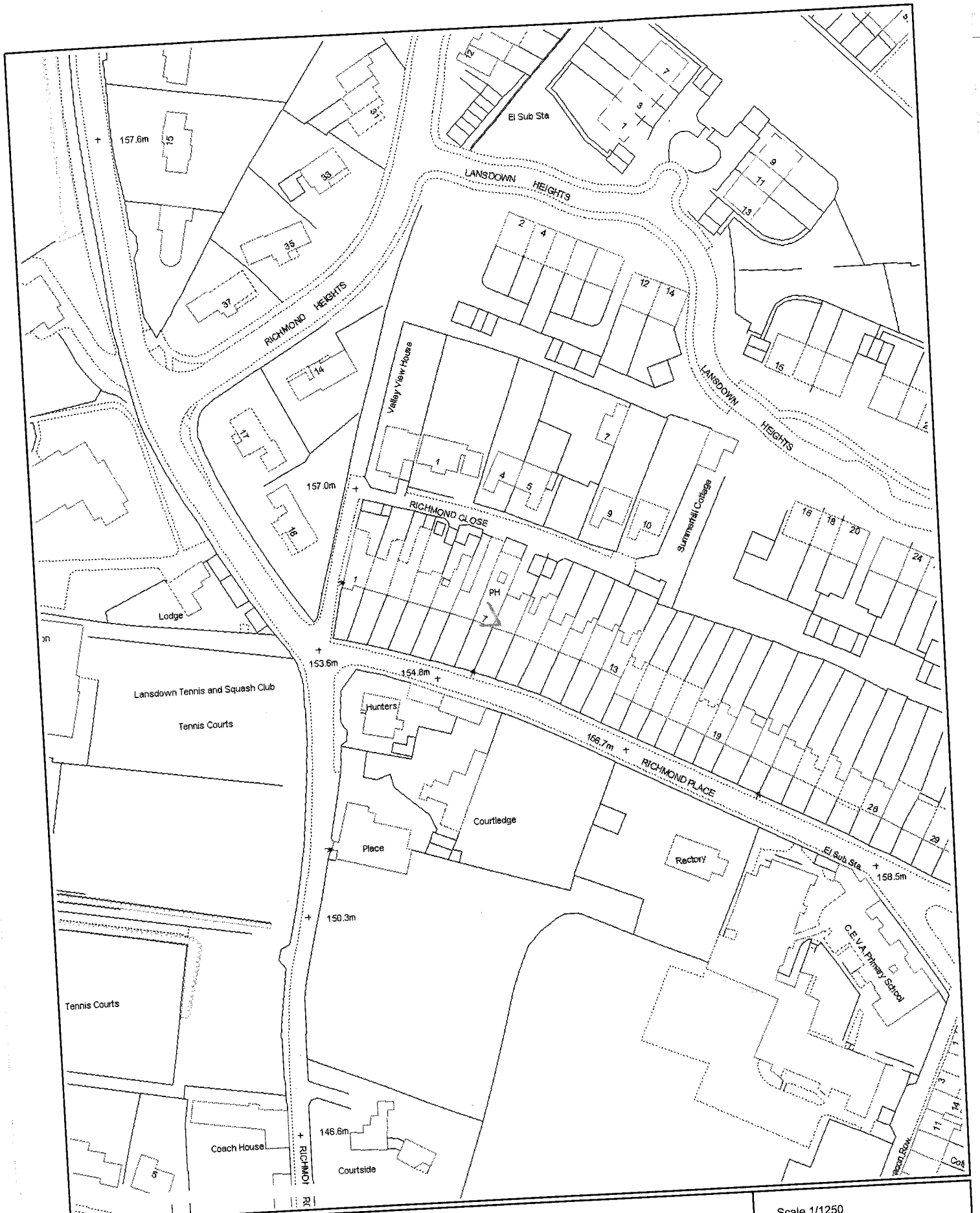

Bath & North East Somerset Council
 Planning Services,
 Trimbridge House,
 Trim Street,
 Bath BA1 2DP

Richmond Arms, 7 Richmond Place



Scale 1/1250
 Date 9/12/2010
 Centre = 374890 E 166392 N
 Drawn by:
 E Stoneman



Representation Form

Responsible Authority. (Please delete as applicable.)

Police / Fire / EP (noise) / Health and Safety / Child Protection / Weights and Measures /
Planning Authority / Marine Agency.

Your Name	Jeremy Lockley
Job Title	Environmental Health Officer
Postal and email address	Environmental Protection 9-10 Bath Street Bath BA1 1SN Jeremy_lockley@bathnes.gov.uk
Contact telephone number	01225 396634

Name of the premises you are making a representation about.	The Richmond Arms
Address of the premises you are making a representation about.	7 Richmond Place Beacon Hill Bath BA1 5PZ

Which of the four licensing objectives does your representation relate to? Please state yes or no.	Yes or No	Please detail the evidence supporting your representation. Or the reason for your representation. Please use separate sheets if necessary.
To prevent crime and disorder	No	
Public safety	No	
To prevent public nuisance	Yes	It is widely recognised that sleep is essential for maintaining physical and mental wellbeing. In my professional opinion the licensing of the first floor of these premises will lead to the significant chance of increased sleep disturbance for the residents who live immediately adjacent to this

		<p>property. Residents either side of the Pub both have bedrooms that could be affected by noise on the first floor, especially if the possibility exists, as it would if this application was permitted, for the area to be used for the playing of recorded and live music. I would strongly recommend a condition that prevents the playing of live and recorded music on the first floor of these premises, and I am surprised the applicant has not offered this. I also have some concerns about the applicant's ability to manage any increase in the noise of customers leaving the establishment late at night; these concerns have been confirmed by the applicant's inability to provide any supporting information related to the prevention of public nuisance within their application for a new premises license.</p>
The prevention of harm to children	No	
Suggested conditions that could be added to the licence to remedy your representation you would like the Licensing Sub Committee to take into account. Please use separate sheets where necessary and refer to checklist.		The first floor area should be used for dining only, and should not be licensed for regulated entertainment.

N.B. If you do make a representation you will be expected to attend the Licensing Panel and any subsequent appeal proceeding.

Signed:

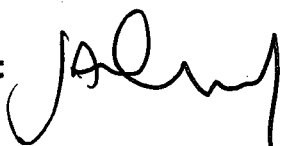

Date:

19/11/2010

Please return this form along with any additional sheets to:

Licensing Team
Public Protection
9-10 Bath Street
Bath
BA1 1SN

E-mail address: licensing@bathnes.gov.uk

This form must be returned within 28 consecutive days of the application being made to the Licensing Authority.



Printed on recycled paper



LICENSING ACT 2003

INTERESTED PARTY REPRESENTATION

ENVIRONMENTAL SERVICES
ANNEX E
16 NOV 2010
Post Log No: 07AB 215486
Receipt No:
CH/OA £:

Please read the notes at the back of this form prior to completing it.

I/We object to the following application:

Application number:	10/03751 / LAPRE
Applicant's name:	Punch Taverns plc
Premises name and address:	RICHMOND ARMS 7 Richmond Place BATH BA1 5PZ
Application for a:	new premises licence

Objector Details:

Objector's Name:	MRS. C. ALEXANDER - JUPP
Objector's Address: This is essential because a representation can only be considered relevant if you live, or are representing an address, in the vicinity of the premises.	30 RICHMOND PLACE BATH BA1 5PA
Organisation name if applicable:	

Objection Details:

My/our representation is relevant to the following licensing objective(s):

- Prevention of crime and disorder
- Prevention of public nuisance
- Protection of children from harm
- Public safety

Please detail your objection(s) as fully as possible in the box below. If you do not then the Committee may not understand why you have objected.

Please attach supporting documents/further pages as necessary and number all extra pages.

Try to be as specific as possible and give examples e.g. *On 1 February I could hear loud music from the premises between 10pm and 1 am. I am concerned that if the premises open until 2 am this will cause a nuisance to me and other residents of the street.*

I/We have already made a written representation and have no further comments

- ① As this road is an exclusively residential area I feel that the extension of working hours will cause problems of noise and disruption especially to the adjoining houses.
- ② Also there is no specific parking to the building and excess traffic or taxis arriving / departing will cause excessive noise or problems late into the night.
- ③ It will also restrict the already limited parking for residents if the hours were increased.

I am aware that a full copy of my representation (including my name and address) will be sent to the applicant and will form part of a public document prior to any hearing on this matter.

Signed

Chris Alexander - Jura

Date

14. 11. 10

Contact telephone number(s)

(This is essential as we may need to contact you at short notice)

LICENSING ACT 2003

INTERESTED PARTY REPRESENTATION

Please read the notes at the back of this form prior to completing it.

I/We object to the following application:

Application number:	10103751 / LAPRE
Applicant's name:	PUNCH TAVERNS PLC
Premises name and address:	RICHMOND ARMS PUBLIC HOUSE 7 RICHMOND PLACE BATH BA1 5PZ
Application for a:	new PREMISES LICENCE

Objector Details:

Objector's Name:	MUR DAVID ANDREWS
Objector's Address: <small>This is essential because a representation can only be considered relevant if you live, or are representing an address, in the vicinity of the premises.</small>	VALLEY VIEW HOUSE RICHMOND CLOSE BATH BA1 5PY
Organisation name if applicable:	

Objection Details:

My/our representation is relevant to the following licensing objective(s):

- Prevention of crime and disorder
- Prevention of public nuisance
- Protection of children from harm
- Public safety

Please detail your objection(s) as fully as possible in the box below. If you do not then the Committee may not understand why you have objected.

Please attach supporting documents/further pages as necessary and number all extra pages.

Try to be as specific as possible and give examples e.g. *On 1 February I could hear loud music from the premises between 10pm and 1 am. I am concerned that if the premises open until 2 am this will cause a nuisance to me and other residents of the street.*

I/We have already made a written representation and have no further comments

My house is directly behind the Richmond Arms and any extension of the licence to permit later opening of the First Floor Function Area is likely to cause noise due to music and loud activities of party nature well beyond reasonable hours very late at night.

The Richmond Arms has been a unique 'pub' as part of a terrace of houses and catering for the local community. For many years it has been a 'gastropub' and not a place of music and function activity that extends to late hours in the heart of a built up area / therefore object to any extension particular of hours associated with the first floor function area, as proposed.

I am aware that a full copy of my representation (including my name and address) will be sent to the applicant and will form part of a public document prior to any hearing on this matter.

Signed

David Andrews

Date

14th November 2010

Contact telephone number(s)

(This is essential as we may need to contact you at short notice)

Bath & North East
Somerset Council

LICENSING ACT 2003

INTERESTED PARTY REPRESENTATION

ENVIRONMENTAL SERVICES
16 NOV 2010
Post Log No: 07/AB 415489
Receipt No:
ONCA 8

Please read the notes at the back of this form prior to completing it.

I/We object to the following application:

Application number:	10/03751 / LAPRE
Applicant's name:	PUNCH TAVERNS P.L.C.
Premises name and address:	RICHMOND ARMS PUBLIC HOUSE, 7, RICHMOND PLACE, BATH BAI SPZ
Application for a:	NEW PREMISES LICENCE

Objector Details:

Objector's Name:	PHILIPPA ANDREWS
Objector's Address: This is essential because a representation can only be considered relevant if you live, or are representing an address, in the vicinity of the premises.	VALLEY VIEW HOUSE RICHMOND CLOSE BATH BAI SPY
Organisation name if applicable:	N/A

Objection Details:

My/our representation is relevant to the following licensing objective(s):

Prevention of crime and disorder

Prevention of public nuisance

Protection of children from harm

Public safety

Please detail your objection(s) as fully as possible in the box below. If you do not then the Committee may not understand why you have objected.

Please attach supporting documents/further pages as necessary and number all extra pages.

Try to be as specific as possible and give examples e.g. *On 1 February I could hear loud music from the premises between 10pm and 1 am. I am concerned that if the premises open until 2 am this will cause a nuisance to me and other residents of the street.*

I/We have already made a written representation and have no further comments

The Richmond Arms is in the middle of a terrace of houses in a quiet residential area. If the new function room's licence to serve alcohol is extended further, there will be the noise of people leaving and starting their cars until midnight and an hour later than this on holidays when they have asked for a later closing time. This is totally inappropriate for the area, and will cause great distress to people living near, especially if they have children or need to get up early for work.

Moreover, parking in the vicinity is already extremely difficult, particularly when the schools are at the end of the school day, and if the pub is open in the day and using its function room it will put even more pressure on parking. Please do not permit the new licence as the noise will cause a nuisance to more than the houses immediately adjacent to the pub, including mine.

I am aware that a full copy of my representation (including my name and address) will be sent to the applicant and will form part of a public document prior to any hearing on this matter.

Signed P. V. Andrews

Date 14th November 2010

Contact telephone number(s)
(This is essential as we may need to contact you at short notice)

Bath & North East
Somerset Council

LICENSING ACT 2003

INTERESTED PARTY REPRESENTATION

ENVIRONMENTAL SERVICES
22 NOV 2010
Post Log No: <i>215681</i>
Receipt No:

Please read the notes at the back of this form prior to completion.

I/We object to the following application:

Application number:	<i>10/03751 / LAPRE</i>
Applicant's name:	<i>THE RICHMOND ARMS</i>
Premises name and address:	<i>RICHMOND PLACE</i>
Application for a:	<i>new licence.</i>

Objector Details:

Objector's Name:	<i>JONATHAN ASTON</i>
Objector's Address: This is essential because a representation can only be considered relevant if you live, or are representing an address, in the vicinity of the premises.	<i>10. RICHMOND PLACE LANSDOWN BATH</i>
Organisation name if applicable:	

Objection Details:

My/our representation is relevant to the following licensing objective(s):

Prevention of crime and disorder

Prevention of public nuisance

Protection of children from harm

Public safety

Please detail your objection(s) as fully as possible in the box below. If you do not then the Committee may not understand why you have objected.

Please attach supporting documents/further pages as necessary and number all extra pages.

Try to be as specific as possible and give examples e.g. *On 1 February I could hear loud music from the premises between 10pm and 1 am. I am concerned that if the premises open until 2 am this will cause a nuisance to me and other residents of the street.*

I/We have already made a written representation and have no further comments

We are unhappy with this application for a new licence for two main reasons: (1) the increase in the hours for drinking, and (2) the additional increase in people who will possibly use the pub. These two reasons mean an increase in noise which is already at very high levels on occasion at leaving time. There are times throughout the year when people leaving the pub are yelling at each other as they "say their goodbyes" on the pavement outside. They bang the doors of their cars, and because some of them have had too much to drink, that driving "leaves a lot to be desired" (i.e. they reverse into the parked car behind, whilst trying to manoeuvre out - only a couple of weeks ago I witnessed some drinks in a 4-wheel drive mount the pavement as they left the pub after 11.00 p.m.). Over the five years we have lived in this road, we have had our cars vandalised three times (mirrors torn off). During warmer weather, when the drinkers are in the pub garden, the noise can reach very loud levels, which, in the evenings, keep both my wife and daughter awake for long stretches of the evening. The people can be very noisy. If there is now going to be live music, this will make the situation intolerable - some of us need our sleep each night, and we usually get up at 6.30 each morning. It would be good if all visitors to the pub leave their cars in Richmond Road, so that when leaving they do not disturb just the residents in Richmond Place. Some of them clearly believe in "drinking and driving", maybe the police would like to monitor the situation, especially on saturday evenings?

I am aware that a full copy of my representation (including my name and address) will be sent to the applicant and will form part of a public document prior to any hearing on this matter.

Signed

Jean Khan J. Aslam

Date

19 November 2010.

Contact telephone number(s)

(This is essential as we may need to contact you at short notice)

4, Richmond Close
Lansdown
BATH
BA1 5PY

3rd November '10

The Licensing Authority
B&NES District Council.

Sir,
The Application for extra hours at Richmond Arms

This is a quiet, residential area of Bath and quite unsuitable for the sort of entertainment that the Richmond Arms proposes to offer. We have many schools in this neighbourhood. It is an unnecessary diversion to have revellers coming into the area just to drink and listen to loud music.

I would like to ask you to reject this petition,

Yours truly

Isabel Barber

ENVIRONMENTAL SERVICES
- 4 NOV 2010
Post Log No: CC/AB 215209
Receipt No:
CH/CA £

LICENSING ACT 2003

ENVIRONMENTAL SERVICES
ANNEX E
16 NOV 2010
Post Log No: 27/Ab 216487
Receipt No:
SH/DA 8

INTERESTED PARTY REPRESENTATION

Please read the notes at the back of this form prior to completing it.

I/We object to the following application:

Application number:	10/03751 / LAPRE
Applicant's name:	PUNCH TAVERNS PCC
Premises name and address:	Richmond Arms 7 Richmond Place Beacon Hill BATH BA1 5PZ
Application for a:	PREMISES LICENCE

Objector Details:

Objector's Name:	MR + MRS M + E BARTON
Objector's Address: <small>This is essential because a representation can only be considered relevant if you live, or are representing an address, in the vicinity of the premises.</small>	7 Richmond Close BATH BA1 5PY
Organisation name if applicable:	

Objection Details:

My/our representation is relevant to the following licensing objective(s):

- Prevention of crime and disorder
- Prevention of public nuisance
- Protection of children from harm
- Public safety

-
-
-
-

Please detail your objection(s) as fully as possible in the box below. If you do not then the Committee may not understand why you have objected.

Please attach supporting documents/further pages as necessary and number all extra pages.

Try to be as specific as possible and give examples e.g. *On 1 February I could hear loud music from the premises between 10pm and 1 am. I am concerned that if the premises open until 2 am this will cause a nuisance to me and other residents of the street.*

I/We have already made a written representation and have no further comments

THE PREMISES ARE IN THE MIDDLE OF A TENSELY POPULATED RESIDENTIAL AREA, SURROUNDED BY FAMILIES WITH YOUNG CHILDREN.

NOISE + PUBLIC NUISANCE ARE A PARAMOUNT CONCERN. AND CAN ONLY INCREASE WITH FURTHER CAPACITY REQUESTED WITHIN THE LICENCE ~~CAPACITY~~ ^{EXTENSION} WITHIN THE LAST MONTH (I HAVE REQUESTED STAFF TO TURN DOWN MUSIC WHICH COULD CLEARLY BE HEARD ALL ALONG RICHMOND CLOSE. I HAVE ALSO CONCERNED ON PREVIOUS OCCASIONS. FIRE + SAFETY ISSUES ARE ALSO A CONCERN DUE TO THE POSITION OF THE LAYOUT (IN A TERRACE (18th) OF BUILDING.

PARKING IS ALREADY PROBLEMATIC WITHIN RICHMOND PLACE + RICHMOND CLOSE + WOULD BECOME WORSE POTENTIALLY A DANGER TO RESIDENTS AND/OR CUSTOMERS.

I am aware that a full copy of my representation (including my name and address) will be sent to the applicant and will form part of a public document prior to any hearing on this matter.

Signed

Date

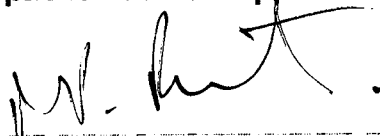
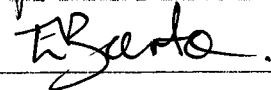
 13.11.10.

Contact telephone number(s)

(This is essential as we may need to contact you at short notice)

()

LICENSING ACT 2003

INTERESTED PARTY REPRESENTATION

ENVIRONMENTAL SERVICES ANNEX E
16 NOV 2010
Post Log No: 97/AB 216485
Receipt No:
CH/CA £:

Please read the notes at the back of this form prior to completing it.

I/We object to the following application:

Application number:	10/03751 / LAPRE
Applicant's name:	PUNCH TAVERNS
Premises name and address:	The Richmond Arms 7 Richmond Place Bath BA1 5PZ
Application for a:	New Premises licence

Objector Details:

Objector's Name:	DAVID + CATHERINE BEAN
Objector's Address: <small>This is essential because a representation can only be considered relevant if you live, or are representing an address, in the vicinity of the premises.</small>	1 Richmond Close Bath BA1 5PY
Organisation name if applicable:	—

Objection Details:

My/our representation is relevant to the following licensing objective(s):

Prevention of crime and disorder

Prevention of public nuisance

Protection of children from harm

Public safety

Please detail your objection(s) as fully as possible in the box below. If you do not then the Committee may not understand why you have objected.

Please attach supporting documents/further pages as necessary and number all extra pages.

Try to be as specific as possible and give examples e.g. *On 1 February I could hear loud music from the premises between 10pm and 1 am. I am concerned that if the premises open until 2 am this will cause a nuisance to me and other residents of the street.*

I/We have already made a written representation and have no further comments

This is a quiet residential neighbourhood and the pub supports that environment and provides a great amenity to the area. However the licence that has been applied for is completely inappropriate to the surrounding area. We are particularly concerned about noise late at night from the proposed music licence (both live and recorded). We are also concerned about the potential increase in traffic in an area already suffering from shortage of parking.

I am aware that a full copy of my representation (including my name and address) will be sent to the applicant and will form part of a public document prior to any hearing on this matter.

Signed

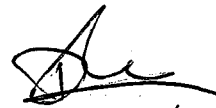
Date

14/11/10

14/11/10

Contact telephone number(s)

(This is essential as we may need to contact you at short notice)

LICENSING ACT 2003

INTERESTED PARTY REPRESENTATION

Please read the notes at the back of this form prior to completing it.

I/We object to the following application:

Application number:	10/03751 / LAPRE
Applicant's name:	
Premises name and address:	
Application for a:	

Objector Details:

Objector's Name:	MRS. E.M. BUTLER
Objector's Address: This is essential because a representation can only be considered relevant if you live, or are representing an address, in the vicinity of the premises.	4, RICHMOND PLACE BATH. BA1 5PZ
Organisation name if applicable:	

Objection Details:

My/~~our~~ representation is relevant to the following licensing objective(s):

Prevention of crime and disorder

Prevention of public nuisance

Protection of children from harm

Public safety

ENVIRONMENTAL SERVICES
- 8 NOV 2010
Post Log No: CD/AB 215284
Receipt No: X
CH/CA £

4, Richmond Place,
Bath
BA1 5PZ

The Licensing Authority
9-10 Bath Street
Bath

4th November 2010

Dear Sirs,

Application by The Richmond Arms

It has come to my attention that Punch Taverns, owners of the Richmond Arms, have applied for a new licence to extend their operating time.

I wish to object to any changes to the current licence. The Richmond Arms is not an isolated public house in the country, or even a detached building, it is part of the oldest continuous Georgian terrace in the country. It is an integral part of this unique residential setting and in its operations must therefore reflect the needs and wishes of the community of which it is a part.

We appreciate the presence of a Public House within the environment and most of us are patrons and make use of its facilities, but we are already overloaded with cars in the road. It is not an area that can accept any increases in traffic and numbers of people.

They are also asking for extensions in the hours of operation. This is a peaceful neighbourhood, something we as residents cherish. As a set of terraced houses we all live in close proximity and all respect the civilised norms of quiet behaviour, especially at night. Significant increases in the numbers of people leaving at times approaching or after midnight is quite unacceptable.

Whilst we understand the need for the Richmond Arms to remain a profitable business this should be done in a sustainable manner reflecting the locale, endless growth is not a prerequisite for a successful operation. I trust you will note these matters and refuse any changes to the current licence.

Yours faithfully,



Mrs E. M. Butler

INTERESTED PARTY REPRESENTATION

Please read the notes at the back of this form prior to completing it.

I/We object to the following application:

Application number:	10/03751
Applicant's name:	PUNCH TAVERN
Premises name and address:	RICHMOND ARMS AKA THE RICHMOND RICHMOND PLACE BATH
Application for a:	NEW PREMISES LICENCE

Objector Details:

Objector's Name:	PAUL CHAUDOIR
Objector's Address: This is essential because a representation can only be considered relevant if you live, or are representing an address, in the vicinity of the premises.	11 RICHMOND CLOSE BATH SP4
Organisation name if applicable:	

Objection Details:

My/our representation is relevant to the following licensing objective(s):

- Prevention of crime and disorder
- Prevention of public nuisance
- Protection of children from harm
- Public safety

Please detail your objection(s) as fully as possible in the box below. If you do not then the Committee may not understand why you have objected.

Please attach supporting documents/further pages as necessary and number all extra pages.

Try to be as specific as possible and give examples e.g. *On 1 February I could hear loud music from the premises between 10pm and 1 am. I am concerned that if the premises open until 2 am this will cause a nuisance to me and other residents of the street.*

I/We have already made a written representation and have no further comments

Doubling the size of the premises potentially doubles the size number of patrons, exiting the pub at times, on certain days of the year, at 2.30 am. You have already received from other residents notice of times when the hours have not been observed, excessive noise (particularly after representation to the staff about observing the licensing hours), and traffic congestion in a quiet residential area. The vast majority of the pub's customers arrive & depart by car.

I am aware that a full copy of my representation (including my name and address) will be sent to the applicant and will form part of a public document prior to any hearing on this matter.

Signed

Paul Park

Date

12 NOV 10

Contact telephone number(s)

(This is essential as we may need to contact you at short notice)

SUMMERHILL COTTAGE, 11 RICHMOND CLOSE, BATH BA1 5PY

B&NES Licensing Authority

1 NOV 10

Dear Sir

I am disappointed to learn that another application has been made by Punch Taverns to increase the business and live music hours of the RICHMOND ARMS.

The arguments that were extensively put forward at the last application still pertain. This small pub is in the midst of a long road of privately owned GRADE II listed terraced houses, in the heart of a quiet respectable neighbourhood. Few local people use the pub and Richmond Place is nearly always full of the house holders' vehicles with little or no space for the pub's motor born trade.

Even with the current opening hours the area is

often disturbed by noisy behaviour ^{which} ~~and~~ is unpleasant to those nearby.

I urge the Licensing Authority to turn down this application: the pub's current opening hours more than suffice.

Yours faithfully

Paul Randoir

ENVIRONMENTAL SERVICES

- 3 NOV 2010

Post Log No:

CC/AB215156

Receipt No:

CH/CA £

ENVIRONMENTAL SERVICES
17 NOV 2010
Post Log No. <i>97/AS 21550</i>
Receipt No:
CH/CA £

ANNEX E

9 Richmond Place
Bath
BA1 5PZ

16 November 2010

Bath and North East Somerset Council Licensing Authority
9-10 Bath Street
Bath
BA1 1SN

Richmond Arms Public House, 7 Richmond Place, Bath, BA1 5PZ – New Premises Licence

Dear Sir,

I would like to voice my objection to the application for the existing license to be extended to a first floor function area for the reasons stated below.

My objections are based around the BANES Statement of Licensing Policy dated 2008.

There are many objections to this application and a great strength of feeling because it is recognised that additions to the present license will have repercussions on the quality of life of the residents. The likely time of the hearing prevents my attendance owing to work commitments but it should not be construed as a diminution of my strength of feeling with regard to this application.

I would ask you to consider the attached points.

Yours faithfully,



Brian Darch

Copied to:
Councillor Anthony Clarke
Councillor David Hawkins

Statement of Licensing Policy	Comment
3.1 Licensing Objectives	Approval of this application will go against the objectives of "The prevention of a public nuisance".
16.18 "Signs to be displayed...."	Past performance has been poor with a sign of minute proportions being displayed and leaving customers being noisy and totally without thought to the residents.
16.18 "Limit on the number of customers..."	Richmond Place is a row of listed Georgian terraced houses totally unsuited to multi-level public entertainment.
17.4 "...applicants discuss any new proposals with neighbours..."	The residents, beyond the immediate next door neighbours, have not been consulted in any way.
19.2 "...impact of activities...."	The increase in numbers and the use of the additional level will have an impact on members of the public living and sleeping in the near vicinity.
23.3 and 23.8 "...control measures and operating schedules..."	Past performance has been poor. The Enforcement Officer has been made aware of breaches of the present license, in particular the garden not being cleared by 1100 during the week, and correspondence on this subject goes back to October 2009. For example the garden was in use on 17 May until 2315, 18 May until 2325, 22 May until 2315 and 24 May until 2320. I question the licensee's willingness to comply with any regulations or have regard for the residents.
23.15 "...public nuisance....noise and smell"	The noise and smell from the kitchen has been a persistent problem and this is well documented over the past decade with little being done to alleviate the problem. An increase in capacity will only exacerbate the problem.
23.15 "...public nuisance....noise"	The use of the 1 st floor for entertainment will be a nuisance to neighbours as the noise travels along the terrace. This will be a particular problem as this is the bedroom level and will undoubtedly disturb sleep if customers are allowed to be entertained and consume food and alcohol beyond 2200. This first floor area should be closed entirely by 2200.
23.15 "...public nuisance ... arriving and departing"	This is a persistent problem late at night and includes the sounding of taxi horns as they announce to clients that they have arrived and are waiting and rowdy customers leaving the premises.
36.1 & 36.2 Local Amenity	The Richmond as it is now called (not the Richmond Arms) caters for a largely non local clientele. The expansion to the 1 st floor has "...a significant potential to adversely impact on our community through public nuisances that arise"
36.6 "...needs of the residents..."	The Licensing Authority is asked to take into account "the needs of the residents". The Authority is also asked to "satisfy itself that adequate measures are in place to prevent public nuisance". Presently this is not the case and past performance gives no measure of confidence that the licensee will put in place adequate measures to reduce the impact on residents. The use of the upstairs lounge for live performance of music is wholly inappropriate for the reasons mentioned above; namely that the majority of residents sleep at the front and on the same level as the new lounge. We would request the Authority consider confining the performance of music to the rear ground floor area of the current bar.

INTERESTED PARTY REPRESENTATION

Please read the notes at the back of this form prior to completion

I/We object to the following application:

Application number:	10/03751 / LAPRE
Applicant's name: <i>Randy Taverns</i>	Jeremy Pk + JOHANNA FITZGERALD
Premises name and address:	24 Richmond Place Bath BA1 5PZ Richmond Arms
Application for a:	New premises License

Objector Details:

Objector's Name:	Jeremy Pk + JOHANNA FITZGERALD
Objector's Address: <small>This is essential because a representation can only be considered relevant if you live, or are representing an address, in the vicinity of the premises.</small>	24 Richmond Place Canford Bath, BA1 5PZ
Organisation name if applicable:	N/A.

Objection Details:

My/our representation is relevant to the following licensing objective(s):

- Prevention of crime and disorder
- Prevention of public nuisance
- Protection of children from harm
- Public safety

Please detail your objection(s) as fully as possible in the box below. If you do not then the Committee may not understand why you have objected.

Please attach supporting documents/further pages as necessary and number all extra pages.

Try to be as specific as possible and give examples e.g. *On 1 February I could hear loud music from the premises between 10pm and 1 am. I am concerned that if the premises open until 2 am this will cause a nuisance to me and other residents of the street.*

I/We have already made a written representation and have no further comments

- + Parking is already very limited on Richmond Place, this will cause further difficulty + inconvenience.
- + Given integral nature of the Richmond Arms within the terrace, we have real concern re noise generated with the proposal, particularly with live music.
- + concern re disruption + noise resulting at unsociable hours from extended opening hours. A large number of families with young children live on the terrace (ourselves included), this residential environment is not conducive to an "expansion" of the Richmond Arms.

I am aware that a full copy of my representation (including my name and address) will be sent to the applicant and will form part of a public document prior to any hearing on this matter.

Signed

She

Date

15.11.12.

Contact telephone number(s)

(This is essential as we may need to contact you at short notice)

ENVIRONMENTAL SERVICES
17 NOV 2010
Post Log No: CD/AB 215560
Receipt No:
GH/GA £:

ANNEX E

3 Richmond Place

Bath

BA15PZ

15 November 2010

Dear Sir,

Application number 10/03751 LAPRE

Richmond Arms, Richmond Place, Bath

I refer to this application to which I wish to register my objection.

This property is set in the heart of what is an otherwise entirely residential area. Historically it has fulfilled the role as a local pub serving the local community. Like many other similar establishments it has in the relatively recent past been up graded to include a restaurant, and become something of a gastro pub. At the time of the upgrading the then owners sought to increase the opening hours and to include a license for music. The application was allowed in part following a full contested hearing subject to restrictions. What has changed since then which might justify an increase in the hours now sought in this application?

Certainly the neighbourhood has not changed, except that parking may have become more of a problem in the intervening period. The fact is this is a terrace of small Georgian houses and cottages, which were built to a specification which would not be acceptable today. They are not well insulated from sound, and the later hours coupled with music will inevitably lead to an increase in disturbance levels, both in volume and duration, which will be a particular problem for those properties close to the Richmond. For the wider locality there will be the substantial risk of disturbance by people and vehicles leaving into the small hours of the morning.

I have no issue with the use of the property as licensed premises per se, and indeed it's presence enhances this unique road. However a balance must be struck, and this application tips it too far in to the realm of a city centre establishment. It is not appropriate for a quiet residential road.

It is particularly galling that this issue is being revisited so relatively soon after the grant of the last license, where nothing has changed, except the aspirations of the owners.

Yours truly,

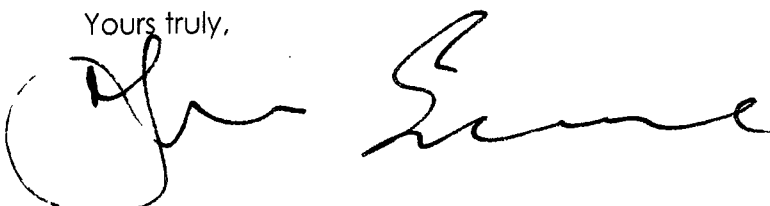
JOHN ARRENE.

Please detail your objection(s) as fully as possible in the box below. If you do not then the Committee may not understand why you have objected.

Please attach supporting documents/further pages as necessary and number all extra pages.

Try to be as specific as possible and give examples e.g. *On 1 February I could hear loud music from the premises between 10pm and 1 am. I am concerned that if the premises open until 2 am this will cause a nuisance to me and other residents of the street.*

I/We have already made a written representation and have no further comments

THE GROUND FLOOR ALREADY HAS A LIMITED LIVE MUSIC LICENCE. THE PREMISES ARE IN A TERRACE AND THE GARDENS ARE SEPARATED BY BATH ASHLAR STONE WALLS, WHICH ACT AS EFFECTIVE BARRIERS FOR NOISE.

MUSIC OR SOUND NOISE FROM THE FIRST FLOOR WOULD NOT BE DEFEATED IN THE SAME WAY. THERE IS VERY LIKELY TO BE A SIGNIFICANT INCREASE IN NOISE POLLUTION IF THIS APPLICATION WAS GRANTED.

THE TERRACE IS A UNIQUE FEATURE OF THE BATH LANDSCAPE, OF WHICH THE RICHMOND ARTS FORUM PART, BUT THIS APPLICATION JEOPARDISES THE UNIQUENESS OF THE AREA.

I am aware that a full copy of my representation (including my name and address) will be sent to the applicant and will form part of a public document prior to any hearing on this matter.

Signed

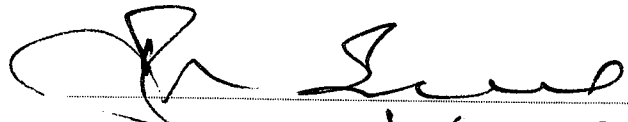

Date

22 NOVEMBER 2010

Contact telephone number(s)
(This is essential as we may need to contact you at short notice).

16 NOV 2010

Post Log No: 07/11/8 215483

Receipt No.....
GH/6A E.....

INTERESTED PARTY REPRESENTATION

Please read the notes at the back of this form prior to completing it.

I/We object to the following application:

Application number:	10/03751 / LAPRE
Applicant's name:	PUNCH TAVERNS PLC
Premises name and address:	THE RICHMOND ARMS 7 RICHMOND PLACE BATH BA1 5PZ
Application for a:	NEW PREMISES LICENCE

Objector Details:

Objector's Name:	GRAHAM F. HARRIS
Objector's Address: This is essential because a representation can only be considered relevant if you live, or are representing an address, in the vicinity of the premises.	5 RICHMOND PLACE BATH BA1 5PZ
Organisation name if applicable:	

Objection Details:

My/~~our~~ representation is relevant to the following licensing objective(s):

Prevention of crime and disorder

Prevention of public nuisance

Protection of children from harm

Public safety

Please detail your objection(s) as fully as possible in the box below. If you do not then the Committee may not understand why you have objected.

Please attach supporting documents/further pages as necessary and number all extra pages.

Try to be as specific as possible and give examples e.g. *On 1 February I could hear loud music from the premises between 10pm and 1 am. I am concerned that if the premises open until 2 am this will cause a nuisance to me and other residents of the street.*

I/We have already made a written representation and have no further comments

THE RICHMOND ARMS IS A SMALL LOCAL ESTABLISHMENT WHICH SEEKS TO INCREASE FOOTFALL AND TRADE, FAIR ENOUGH.
HOWEVER THIS CAN ONLY BE DONE BY IMPOSING FURTHER UPON RESIDENTS OF RICHMOND PLACE AND NEARBY, WE ALREADY FIND THE STREET WELL OCCUPIED BY STAFF AND CUSTOMER PARKING, WE ALREADY HAVE CEASED LATE NIGHT SITTING IN OUR GARDENS AND WE ALREADY ARE RESIGNED TO THE CHEERY FAREWELLS AND DOOR SLAMMING AT ANY TIME AROUND MIDNIGHT.

HAVING LIVED CLOSE TO THE RICHMOND FOR 30 YEARS ITS PRESENCE HAS ALWAYS BEEN AN APPRECIATED ADDITION TO RICHMOND PLACE, ITS PROFILE HAS BEEN ENLARGED OVER RECENT YEARS AND IN ORDER TO SURVIVE CHANGE OBVIOUSLY HAD TO BE IMPLEMENTED.

TO GO FURTHER — AS THESE PLANS PROPOSE — WOULD DESTROY THAT DELICATE BALANCE.

I am aware that a full copy of my representation (including my name and address) will be sent to the applicant and will form part of a public document prior to any hearing on this matter.

Signed

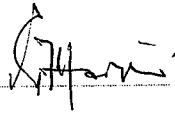

Date

11 NOV 10

Contact telephone number(s)

(This is essential as we may need to contact you at short notice)

LICENSING ACT 2003

INTERESTED PARTY REPRESENTATION

ENVIRONMENTAL SERVICES
ANNEX
18 NOV 2010
Post Log No. 07/AB 215592
Receipt No. CHBA E

Please read the notes at the back of this form prior to completing it.

I/We object to the following application:

Application number:	10/03751 / LAPRE
Applicant's name:	
Premises name and address:	7 RICHMOND PLACE (RICHMOND ARMS) BEACON HILL BATH BA1 5PZ
Application for a:	NEW PREMISES LICENSE

Objector Details:

Objector's Name:	MR ANTHONY HUGHES
Objector's Address: <small>This is essential because a representation can only be considered relevant if you live, or are representing an address, in the vicinity of the premises.</small>	10 RICHMOND CLOSE BATH BA1 5PY
Organisation name if applicable:	

Objection Details:

My/our representation is relevant to the following licensing objective(s):

Prevention of crime and disorder

Prevention of public nuisance

Protection of children from harm

Public safety

Please detail your objection(s) as fully as possible in the box below. If you do not then the Committee may not understand why you have objected.

Please attach supporting documents/further pages as necessary and number all extra pages.

Try to be as specific as possible and give examples e.g. On 1 February I could hear loud music from the premises between 10pm and 1 am. I am concerned that if the premises open until 2 am this will cause a nuisance to me and other residents of the street.

I/We have already made a written representation and have no further comments

I object to this application on the grounds that it will significantly increase the level of disruption caused by this premises to the surrounding residential area.

Although ~~has~~ ^{and} recorded music license already exists on this premise, any extension to the opening hours of licensed premises area will substantially increase the noise nuisance and could well lead to an increase in anti-social behaviour or public disorder due to the nature of the surrounding area, i.e. it is almost entirely residential, already suffers from large volumes of traffic at peak times, has limited parking opportunities and single track roads.

Noise from this premises is already a significant problem in our area and has become worse at the rear of the premises since the kitchen facilities were extended earlier in the year. Litter at the rear of the premises is already a nuisance, as are the number of deliveries made to the premises, which on all occasions block access to Richmond Close. Granting this licence will ~~if~~ ^{sure} significantly impact my ability and that of ~~other~~ ^{other} residents of Richmond Close to make reasonable

I am aware that a full copy of my representation (including my name and address) will be sent to the applicant and will form part of a public document prior to any hearing on this matter.

Signed



Date

18th Nov 2010

Contact telephone number(s)

(This is essential as we may need to contact you at short notice)

use of our own property causing by the restrictions no access and increased noise nuisance.

LICENSING ACT 2003

INTERESTED PARTY REPRESENTATION

ENVIRONMENTAL SERVICES ANNEX B
17 NOV 2010
Post Log No: 07/AB 015533
Receipt No:
CH/S/8 it

Please read the notes at the back of this form prior to completion.

I/We object to the following application:

Application number:	10/03751 / LAPRE
Applicant's name:	PUNCH TAYERNS Plc
Premises name and address:	RICHMOND ARMS PUBLIC HOUSE, 7 RICHMOND PLACE, BATH, BA1 5PZ
Application for a:	NEW PREMISES LICENCE

Objector Details:

Objector's Name:	ANTHONY LUTTRELL
Objector's Address: <small>This is essential because a representation can only be considered relevant if you live, or are representing an address, in the vicinity of the premises.</small>	20 RICHMOND PLACE, BATH BA1 5PZ
Organisation name if applicable:	—

Objection Details:

My/our representation is relevant to the following licensing objective(s):

Prevention of crime and disorder

Prevention of public nuisance

Protection of children from harm

Public safety

Please detail your objection(s) as fully as possible in the box below. If you do not then the Committee may not understand why you have objected.

Please attach supporting documents/further pages as necessary and number all extra pages.

Try to be as specific as possible and give examples e.g. *On 1 February I could hear loud music from the premises between 10pm and 1 am. I am concerned that if the premises open until 2 am this will cause a nuisance to me and other residents of the street.*

I/We have already made a written representation and have no further comments

PLEASE SEE ENCLOSED SHEET

I am aware that a full copy of my representation (including my name and address) will be sent to the applicant and will form part of a public document prior to any hearing on this matter.

Signed

A. Zuhra

Date

15 November 2010

Contact telephone number(s)

(This is essential as we may need to contact you at short notice)

OBJECTIONS CONCERNING THE RICHMOND ARMS

1. It seems strange that so much expensive work has been done on this site before the application for licences has been considered.
2. Residents quite recently spent considerable time and money opposing similar applications; it seems wrong that the pub owners can repeat broadly similar applications in the hope of eventually securing what they want.
3. Protesters may not discuss traffic or parking, so I cannot do so; but I protest against a bizarre system that prevents the authority considering a major objection to the application.
4. The application would, if granted, lead to troubles with noise, street violence, smells, damage to property, vomiting and so on; this has already been recognized in great detail at the previous hearing. We do not have police officers to keep order in our street.
5. The application would, if granted, evidently cause financial losses to residents selling their houses.
6. Local residents choose to live, and to pay high rates, in a pleasant residential environment; they do not want the unpleasant kind of development proposed.

15 November 2010

Dr. Anthony Luttrell

- 2 NOV 2010

Post Log No:
Receipt No: **ANNEX E**
CH/CA £.....

Gillian M Mann
6 Richmond Place
Lansdown
Bath
BA1 5PZ

30 October 2010

Dear Sir/ Madam,

I wish to take issue with the proposed extension of the hours to
The current Premises Licence of The Richmond Arms, Richmond
Place, Bath, BA1 5PZ.

This is a very quiet, completely residential area, where the houses
are all Terraced.

I have lived here for 25 years and seen numerous licensees come and go.
I live right next to the public house and have to already endure the noise
which already comes from the garden.

The previous landlady took out all the shrubs her side of the wall,
which use to absorb some of the noise, so she could increase the seating
capacity in the garden, placing the tables right next to our adjoining
wall.

There is a table directly under my bedroom window and next to my front
door. In the hot weather my windows have to remain closed.

The noise is so great at times that I have to increase the volume on my
television or wear earphones, when relaxing in the evening.

I know that the legal notice says that the application is to be added to
The existing terms. I want to be reassured that that those terms are
adhered to – The beer garden is vacated by 11pm Monday to Saturday,
10.30 on a Sunday.

I have had to remind the staff, in the pub, on numerous occasions by
telephoning them.

The new function room adjoins my bedroom, I have been told that
They have soundproofed this wall, but this has yet to be put to the
test.

The application for live music 12 times a year is totally unacceptable
the properties are small and the sound carries in this very quiet residential
area, we already have to endure the Lansdown Tennis Club
functions which can be heard very clearly.

The doors and windows of the Richmond Arms are already left open after the time restrictions of the existing licence.

I know when I moved into my property that it had been a public house for numerous years but over the years so many changes have been made which seem to be in favour of the licensees and not the local community in which it is supposed to fit in.

So I am completely against any of these proposed changes that are being proposed. We have to consider each other and also protect our quality of life.

Yours sincerely

G. M. Mann

G. M. Mann (Mrs)

INTERESTED PARTY REPRESENTATION

ENVIRONMENTAL SERVICES
ANNEX E
- 5 NOV 2010
Post Log No: CD/AB 215229
Receipt No: X
CH/DA £:

Please read the notes at the back of this form prior to completing it.

I/We object to the following application:

Application number:	10/03751 / LAPRE
Applicant's name:	Sylvia Mizel
Premises name and address:	Richmond Arms 7. Richmond Place BA1 5PZ
Application for a:	Extension of hours

Objector Details:

Objector's Name:	Mrs G.M. Mann
Objector's Address: <small>This is essential because a representation can only be considered relevant if you live, or are representing an address, in the vicinity of the premises.</small>	6. Richmond Place BA1 5PZ
Organisation name if applicable:	Punch Taverns.

Objection Details:

My/our representation is relevant to the following licensing objective(s):

- Prevention of crime and disorder
- Prevention of public nuisance
- Protection of children from harm
- Public safety

Please detail your objection(s) as fully as possible in the box below. If you do not then the Committee may not understand why you have objected.

Please attach supporting documents/further pages as necessary and number all extra pages.

Try to be as specific as possible and give examples e.g. *On 1 February I could hear loud music from the premises between 10pm and 1 am. I am concerned that if the premises open until 2 am this will cause a nuisance to me and other residents of the street.*

I/We have already made a written representation and have ~~no~~ further comments



I have already made a written representation, but I missed off some additional concerns

1) The diners in the new dining-room will have to come into the garden during and after 11pm at night, thus bringing noise adjacent to my sitting-room and bedroom.

They may not be drinking, so what are the implications, the present license states the gardens must be vacated by 11pm.

2. Taxis and cars picking up customers and diners already cause a problem with beeping horns and slamming doors late at night causing me and other residents a nuisance.

I am aware that a full copy of my representation (including my name and address) will be sent to the applicant and will form part of a public document prior to any hearing on this matter.

Signed

G. M. Mann

Date

12 November 2010

Contact telephone number(s)

(This is essential as we may need to contact you at short notice)

LICENSING ACT 2003

INTERESTED PARTY REPRESENTATION

ENVIRONMENTAL SERVICES
ANNEX E
16 NOV 2013
Post Log No: 07/AB 215484
Receipt No: 07/01

Please read the notes at the back of this form prior to completing it.

I/We object to the following application:

Application number:	
Applicant's name:	MS S. MIZEL
Premises name and address:	The Richmond Arms 7, Richmond Place Lansdown Bath.
Application for a:	Licence for 1st Floor area.

Objector Details:

Objector's Name:	Mrs G.M. Mann
Objector's Address: This is essential because a representation can only be considered relevant if you live, or are representing an address, in the vicinity of the premises.	6, Richmond Place Lansdown Bath BA1 5PZ
Organisation name if applicable:	

Objection Details:

My/our representation is relevant to the following licensing objective(s):

- Prevention of crime and disorder
- Prevention of public nuisance
- Protection of children from harm
- Public safety

Please detail your objection(s) as fully as possible in the box below. If you do not then the Committee may not understand why you have objected.

Please attach supporting documents/further pages as necessary and number all extra pages.

Try to be as specific as possible and give examples e.g. *On 1 February I could hear loud music from the premises between 10pm and 1 am. I am concerned that if the premises open until 2 am this will cause a nuisance to me and other residents of the street.*

I/~~We~~ have already made a written representation and have no further comments

Thank you for your reply, but my concerns over the licence to have live music in the upstairs area has not been addressed. My bedroom is right next to the room in question and as these are terraced cottages, the noise that will carry across to the adjoining houses ^{to} ~~with~~ ^{are} me unacceptable. As I said in my previous correspondence that the noise from the garden at times encroaches on my life to such an extent that I have to raise my sound level of T.V etc or wear earphones. This room will be used for parties etc so where is my protection!!!

I am aware that a full copy of my representation (including my name and address) will be sent to the applicant and will form part of a public document prior to any hearing on this matter.

Signed G. M. Mann

Date 13th November 2010

Contact telephone number(s)
(This is essential as we may need to contact you at short notice)

LICENSING ACT 2003

INTERESTED PARTY REPRESENTATION

ENVIRONMENTAL SERVICES
ANNEX E
22 NOV 2019
Post Log No: <u>EP/AB 215682</u>
Receipt No:
CH/GA £:

Please read the notes at the back of this form prior to completing it.

I/We object to the following application:

Application number:	10/03751 / LAPRE
Applicant's name:	PUNCH TAVERNS PLC
Premises name and address:	RICHMOND ARMS PUBLIC HOUSE 7 RICHMOND PLACE BATH BA1 5PZ
Application for a:	NEW PREMISES LICENCE

Objector Details:

Objector's Name:	MR & MRS D. W. PARSONS
Objector's Address: This is essential because a representation can only be considered relevant if you live, or are representing an address, in the vicinity of the premises.	1 RICHMOND PLACE BATH, BA1 5PZ
Organisation name if applicable:	/

Objection Details:

My/our representation is relevant to the following licensing objective(s):

- Prevention of crime and disorder
- Prevention of public nuisance
- Protection of children from harm
- Public safety

Please detail your objection(s) as fully as possible in the box below. If you do not then the Committee may not understand why you have objected.

Please attach supporting documents/further pages as necessary and number all extra pages.

Try to be as specific as possible and give examples e.g. *On 1 February I could hear loud music from the premises between 10pm and 1 am. I am concerned that if the premises open until 2 am this will cause a nuisance to me and other residents of the street.*

I/We have already made a written representation and have no further comments

WE HAVE EXPERIENCED SOME NOISE WHEN PEOPLE LEAVE THE PUB LATE AT NIGHT, TALKING LOUDLY & SLAMMING CAR DOORS. EXTENDED HOURS WILL INEVITABLY MOVE THE NOISE TO THE EARLY HOURS OF THE MORNING. MOST VISITORS CLOSER TO OUR HOUSE DUE TO THE VERY LIMITED SPACE AVAILABLE IN RICHMOND PLACE.

WE LIVE FAR ENOUGH AWAY FROM THE PUB NOT TO BE DISTURBED BY MUSIC PLAYED WITHIN THE BUILDING. THERE WOULD BE SIGNIFICANT DISTURBANCE IF MUSIC IS PLAYED OUTSIDE, AND WE OBJECT IF THIS IS BEING CONSIDERED.

PARKING IS ALWAYS RESTRICTED IN RICHMOND PLACE AND VISITORS INEVITABLY PARK IN RICHMOND ROAD, CAUSING TRAFFIC RESTRICTIONS ON RICHMOND ROAD BETWEEN RICHMOND HILL AND CHARLCOMBE LANE THIS MAINLY OCCURS AT SCHOOL TIMES IN THE MORNING & AFTERNOON BUT EXTENDED PUB OPENING HOURS WILL COMPOUND THE PROBLEM. CONSIDERATION SHOULD BE GIVEN TO THE FACT THAT THE RICHMOND ARMS IS SITUATED IN A HIGH DENSITY RESIDENTIAL AREA WHERE INCREASED ACTIVITY HAS A GREATER IMPACT ON RESIDENTS.

I am aware that a full copy of my representation (including my name and address) will be sent to the applicant and will form part of a public document prior to any hearing on this matter.

Signed



Date

18 NOV 2010

Contact telephone number(s)

(This is essential as we may need to contact you at short notice)

INTERESTED PARTY REPRESENTATION

- 8 NOV 2010

Post Log No: CD/AB215280
Receipt No:
CH/CA: 2.....

Please read the notes at the back of this form prior to completing it.

I/We object to the following application:

Application number:	10/03751 / LAPRE
Applicant's name:	ISOBEL PONTING Punch Taverns PLC
Premises name and address:	7 ¹³ RICHMOND PLACE LANSDOWN BATH BA1 5PZ
Application for a:	granting of new Premises Licence

Objector Details:

Objector's Name:	ISOBEL PONTING
Objector's Address: This is essential because a representation can only be considered relevant if you live, or are representing an address, in the vicinity of the premises.	13 RICHMOND PLACE LANSDOWN, BATH BA1 5PZ
Organisation name if applicable:	

Objection Details:

My/our representation is relevant to the following licensing objective(s):

- Prevention of crime and disorder
- Prevention of public nuisance
- Protection of children from harm
- Public safety

Please detail your objection(s) as fully as possible in the box below. If you do not then the Committee may not understand why you have objected.

Please attach supporting documents/further pages as necessary and number all extra pages.

Try to be as specific as possible and give examples e.g. *On 1 February I could hear loud music from the premises between 10pm and 1 am. I am concerned that if the premises open until 2 am this will cause a nuisance to me and other residents of the street.*

I/We have already made a written representation and have no further comments

I am against any extension of drinking hours. If you had seen my beaut. but, talented, daughter, mother of six children, but alcoholic, who died 3 weeks ago, after crashing her skull and never regaining consciousness, you would want to reduce the opening hours, not extend them.

It was all too easy to get alcohol at the Richmond Arms, morning, noon, & night.

Her sad, turbulent life ended at 55yrs, leaving everything that would have made her life worthwhile. Think about her, and all the many young people, who are ruining their lives from the accessibility, to alcohol, almost round the clock. RIP.

I am aware that a full copy of my representation (including my name and address) will be sent to the applicant and will form part of a public document prior to any hearing on this matter.

Signed

Isobel Poutney

Date

4/11/10

Contact telephone number(s)

(This is essential as we may need to contact you at short notice)

LICENSING ACT 2003

INTERESTED PARTY REPRESENTATION

ENVIRONMENTAL SERVICES
ANNEX E
19 NOV 2010
Post Log No: 97/AB 215 (63)
Receipt No:
CH/CA £.....

Please read the notes at the back of this form prior to completing it.

I/We object to the following application:

Application number:	10/03751 / LAPRE
Applicant's name:	
Premises name and address:	
Application for a:	

Objector Details:

Objector's Name:	Jennifer Sleep.
Objector's Address: This is essential because a representation can only be considered relevant if you live, or are representing an address, in the vicinity of the premises.	35, Richmond Place Bath. BA1 5QA
Organisation name if applicable:	

Objection Details:

My/our representation is relevant to the following licensing objective(s):

Prevention of crime and disorder

Prevention of public nuisance

Protection of children from harm

Public safety

Please detail your objection(s) as fully as possible in the box below. If you do not then the Committee may not understand why you have objected.

Please attach supporting documents/further pages as necessary and number all extra pages.

Try to be as specific as possible and give examples e.g. *On 1 February I could hear loud music from the premises between 10pm and 1 am. I am concerned that if the premises open until 2 am this will cause a nuisance to me and other residents of the street.*

I/We have already made a written representation and have no further comments



[Empty box for objections]

I am aware that a full copy of my representation (including my name and address) will be sent to the applicant and will form part of a public document prior to any hearing on this matter.

Signed

Jennifer Sleep

Date

20. 11. 2010

Contact telephone number(s)
(This is essential as we may need to contact you at short notice)

Application No 10/03751/LAPRE

I am truly appalled to see this application for extended licensing hours and live music at the Richmond Arms. My strong objections to the proposal are 2 fold:

1. Prevention of public nuisance

This proposal is designed to drastically extend the licensing hours of a noisy pub situated within a wholly residential area. Alcohol intake is known to raise the volume of conversation (witness any busy pub). People leaving these premises in the early hours of the morning would inevitably create a public noise nuisance and disturbance to local families, potentially on a weekly basis. This would be impossible to control. The pub also has a large outdoor seating area (equal to the inside dining space) so during the summer months, and throughout the year for smokers, people sit outside when voices carry some distance. The inclusion of a licence to have live music (albeit on a limited number of occasions) would substantially add to the noise factor totally at odds with this quiet residential area. Pity the poor neighbours.

2. Public safety and prevention of crime and disorder.

I note that the purpose of the proposed 'function room' is not provided in the application. It would seem therefore that it could be used for anything from small conferences, extended dining space or weddings. Any/all of these activities would involve a substantial increase in the number of people attending the venue. As you will be well aware, car parking is already at a premium in the immediate vicinity of the pub. At times, it is a nightmare scenario for residents trying to find somewhere to park their cars especially when returning home after work or late in the evening. The addition of a 'function room' at the pub can only mean a requirement for additional parking which could be substantial. This could jeopardise public safety as desperate guests jostle to find parking space in an already seriously congested area. In addition, cars leaving in numbers in the small hours would contribute to the invasive noise of doors slamming, engines revving and general the bon amie of departing guests – all this on a regular, even weekly basis.

I appreciate that as this is essentially a proposal to increase licensing hours, parking is not a major concern to planners, it is however, a very major concern to the residents. Parking congestion presents a real public safety problem with associated opportunity for potential crime and disorder.

In addition, I note that a street sign has been mounted outside the pub without the necessary planning permission. It seems that the owners are intent on riding rough shod over the planning authority as well as the local community.

Jennifer Deep
35, Richmond Place

LICENSING ACT 2003

INTERESTED PARTY REPRESENTATION

ENVIRONMENTAL SERVICES

ANNEX E

19 NOV 2010

Post Log No: CD/AB 2156ES

Receipt No: X

Please read the notes at the back of this form prior to completing it.

I/We object to the following application:

Application number:	10/03751 / LAPRE
Applicant's name:	PUNCH TAVERNS PLC
Premises name and address:	Richmond Arms Public House 7 Richmond Place Bath, BA1 5PZ
Application for a:	New Premises Licence

Objector Details:

Objector's Name:	K+K. STRINGER
Objector's Address: This is essential because a representation can only be considered relevant if you live, or are representing an address, in the vicinity of the premises.	11 Richmond Place Bath BA1 5PZ
Organisation name if applicable:	—

Objection Details:

My/our representation is relevant to the following licensing objective(s):

Prevention of crime and disorder

Prevention of public nuisance

Protection of children from harm

Public safety

Please detail your objection(s) as fully as possible in the box below. If you do not then the Committee may not understand why you have objected.

Please attach supporting documents/further pages as necessary and number all extra pages.

Try to be as specific as possible and give examples e.g. *On 1 February I could hear loud music from the premises between 10pm and 1 am. I am concerned that if the premises open until 2 am this will cause a nuisance to me and other residents of the street.*

I/We have already made a written representation and have no further comments

We object because this will change the character of the pub, increasing the number of customers and making it totally unsuitable for a Georgian terraced property on an otherwise quiet, residential street. The additional noise generated by the customers will affect our family's ability to enjoy quality of life in our home - we are already disturbed on numerous occasions by noisy customers leaving the pub and by noisy customers in the pub garden - which is also the designated smoking area. Increasing the pub's capacity will exacerbate this.

I am aware that a full copy of my representation (including my name and address) will be sent to the applicant and will form part of a public document prior to any hearing on this matter.

Signed

Date

JA John
20/11/10 20/11/10

Contact telephone number(s)

(This is essential as we may need to contact you at short notice)

LICENSING ACT 2003

INTERESTED PARTY REPRESENTATION

Please read the notes at the back of this form prior to completing it.

I/We object to the following application:

Application number:	10/03751 / LAPRE
Applicant's name:	PUNCH TAVERNS PLC
Premises name and address:	RICHMOND ARMS PUBLIC HOUSE 7 RICHMOND PLACE BATH, BA1 5PZ
Application for a:	NEW PREMISES LICENCE

Objector Details:

Objector's Name:	MR + MRS M J SYMONS
Objector's Address: This is essential because a representation can only be considered relevant if you live, or are representing an address, in the vicinity of the premises.	YORK PLACE RICHMOND ROAD BATH BA1 5PU
Organisation name if applicable:	

Objection Details:

My/our representation is relevant to the following licensing objective(s):

Prevention of crime and disorder

Prevention of public nuisance

Protection of children from harm

Public safety

Please detail your objection(s) as fully as possible in the box below. If you do not then the Committee may not understand why you have objected.

Please attach supporting documents/further pages as necessary and number all extra pages.

Try to be as specific as possible and give examples e.g. *On 1 February I could hear loud music from the premises between 10pm and 1 am. I am concerned that if the premises open until 2 am this will cause a nuisance to me and other residents of the street.*

I/We have already made a written representation and have no further comments

PLEASE SEE COVERING LETTER.

I am aware that a full copy of my representation (including my name and address) will be sent to the applicant and will form part of a public document prior to any hearing on this matter.

Signed

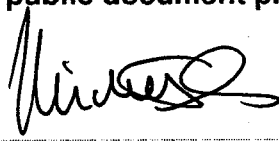
 Mr P SYMONS

Date

17/11/10

Contact telephone number(s)
(This is essential as we may need to contact you at short notice)

MICHAEL SYMONS

Michael & Patricia Symons
York Place
Richmond Road
BATH
BA1 5PU

ENVIRONMENTAL SERVICES ANNEX E
19 NOV 2010
Post Log No: <i>9/AB 215636</i>
Receipt No:
CH/CA £

Bath & North East Somerset
District Council Licensing Authority
9-10 Bath Street
Bath, BA1 1SN

17 November 2010

Dear Sirs

Re: Richmond Arms, Richmond Place, Bath – Application No: 10/03751/LAPRE

We attach a formal objection to the above application from which you will see that we have referred to this covering letter for details of our representation.

We object because we feel that the premises are inappropriate for both late drinking and music licences in view of the location of the premises. The pub forms part of a Georgian terrace of cottages and is in an exclusively residential area. There are two schools close by and many of the properties in that area are occupied by families with children. Whilst our house is actually in Richmond Road the back of the house faces the pub and is around 75 yards away. The noise of both live music and late revellers leaving the premises could be very disruptive to local neighbours trying to sleep!

We would mention (and this is not an insignificant point) that Punch Taverns applied for an extended licence five years ago which was strongly opposed by residents. My wife and I personally financed legal representation at a cost of some £2500 resulting in negotiations between the parties and the current arrangements being agreed before being put to the Licensing Committee.

In view of the cost we are reluctant to do the same again when this matter has already been settled once.

We would also please ask the Committee when considering the matter to re-instate the existing "lock in" provision and the other conditions requiring closure of doors and windows etc.

We would be very grateful if you could please take into account our objection.

Many thanks,

Yours faithfully,

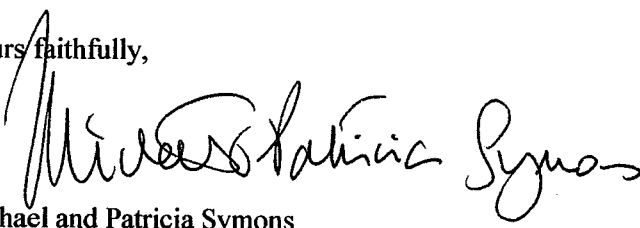

Michael and Patricia Symons

LICENSING ACT 2003

INTERESTED PARTY REPRESENTATION

ENVIRONMENTAL SERVICES
ANNEX E
- 8 NOV 2010
Post Log No: CD/AB215277
Receipt No:

Please read the notes at the back of this form prior to completing it

I/We object to the following application:

Application number:	10/03751 / LAPRE
Applicant's name:	MR ROBERT C. TAYLOR
Premises name and address:	HUNTERS LEIGH, RICHMOND ROAD, LANSDOWN, BATH BA1 5PU
Application for a:	A PREMISES EXTENSION OF TIME FOR RICHMOND ARMS.

Objector Details:

Objector's Name:	
Objector's Address: This is essential because a representation can only be considered relevant if you live, or are representing an address, in the vicinity of the premises.	ABOVE.
Organisation name if applicable:	

Objection Details:

My/our representation is relevant to the following licensing objective(s):

- Prevention of crime and disorder
- Prevention of public nuisance
- Protection of children from harm
- Public safety

Please detail your objection(s) as fully as possible in the box below. If you do not then the Committee may not understand why you have objected.

Please attach supporting documents/further pages as necessary and number all extra pages.

Try to be as specific as possible and give examples e.g. *On 1 February I could hear loud music from the premises between 10pm and 1 am. I am concerned that if the premises open until 2 am this will cause a nuisance to me and other residents of the street.*

I/We have already made a written representation and have no further comments

This objection is for perceived noise and nuisance at a late hour. at the moment there is very little disturbance, but now this probably ^{will} change with live music if this would be allowed to go through. This probably is just the beginning to further extention in the future. I would rather leave things as they are where most residents are quite happy with very little or no problems as such. I am not against the pub, in fact I do use it from time to time, but this just a step to far, to this quite residential area.

I am aware that a full copy of my representation (including my name and address) will be sent to the applicant and will form part of a public document prior to any hearing on this matter.

Signed *Thank you for given me this opportunity to voice my opinion.*

Date

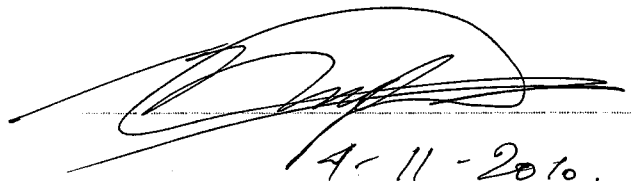
14-11-2010.

Contact telephone number(s)
(This is essential as we may need to contact you at short notice)

12 NOV 2010

Post Log No: 07/AB.215416

Receipt No:

CH/CA £

LICENSING ACT 2003

INTERESTED PARTY REPRESENTATION

Please read the notes at the back of this form prior to completing it.

I/We object to the following application:

Application number:	10/03751 / LAPRE
Applicant's name:	BEATRICE VARMA
Premises name and address: 21 RICHMOND PL. BATH BA1 5PZ	
Application for a:	

Objector Details:

Objector's Name:	
Objector's Address: This is essential because a representation can only be considered relevant if you live, or are representing an address, in the vicinity of the premises.	
Organisation name if applicable:	

Objection Details:

My/our representation is relevant to the following licensing objective(s):

Prevention of crime and disorder

Prevention of public nuisance

Protection of children from harm

Public safety

Please detail your objection(s) as fully as possible in the box below. If you do not then the Committee may not understand why you have objected.

Please attach supporting documents/further pages as necessary and number all extra pages.

Try to be as specific as possible and give examples e.g. *On 1 February I could hear loud music from the premises between 10pm and 1 am. I am concerned that if the premises open until 2 am this will cause a nuisance to me and other residents of the street.*

I/We have already made a written representation and have no further comments



Dear Sirs,

I write to you about 1 week ago a private club starting string up. My objection to to give Punk Taverns Plc the Richmond Arms of 7 Richmond Place the Premise licence to use a 2 functions above the pub.

The reasons are stated above

I am aware that a full copy of my representation (including my name and address) will be sent to the applicant and will form part of a public document prior to any hearing on this matter.

Signed

Bianca Varma

Date

10/02/2016

Contact telephone number(s)
(This is essential as we may need to contact you at short notice)

Bath + North East Somerset District Council
Licensing Authority
9-10 Bath Street
BATH BA1 1SN

5 Nov 2010
ENVIRONMENTAL SERVICES
- 8 NOV 2010
Post Log No: CD/AB215278
Receipt No:
CH/PA #:

Dear Sirs,

I have been living more than 35 years in 21 RICHMOND PL.
I have seen many changes during this time but I object
to give a Licence to the owner of the Richmond Arms Pub
for adding a new first floor function area. This is not in
the spirit of this old Pub and of Richmond place in general.

The idea that they are going to serve from 11am - 11pm
each week day and 12am to 10.30 pm on Sundays plus
an additional 30 min each day for drinking up time,
will create noise right into the small hours of the
night with additional lack of parking space already
congested as it is.

He also wants to add on top of this on Bank holiday weekends,
Easter weekends, Christmas + New Year thus prolonging
the leaving time right into very late night + early
mornings.

I am pleading that you will not give permission this
to happen and that Richmond Place remains a quiet
residential area that every can enjoy. We have enough
activities and problems with the school activities
during term times!

Sincerely Beatrix Varma

LICENSING ACT 2003

INTERESTED PARTY REPRESENTATION

ENVIRONMENTAL SERVICES
ANNEX E
 15 NOV 2010
 Post Log No: 07/AB 215450
 Receipt No:
 CH/GA €:

Please read the notes at the back of this form prior to completing it.

I/We object to the following application:

Application number:	10/03751 / LAPRE
Applicant's name:	Punk Taverns plc
Premises name and address:	Richmond Arms Public House 7 Richmond Place Bath BA1 5PZ
Application for a:	New premises licence on existing terms

Objector Details:

Objector's Name:	ANN MARY WHYBROW
Objector's Address: This is essential because a representation can only be considered relevant if you live, or are representing an address, in the vicinity of the premises.	16 RICHMOND PLACE LANSDOWN BATH BA1 5PZ
Organisation name if applicable:	

& condition as existing licence following addition of 1st floor ~~licence~~ area + additional work every Fri/Sat/Sun Mon
 to Bath H.S.U.

Objection Details:

My/~~our~~ representation is relevant to the following licensing objective(s):

- Prevention of crime and disorder
- Prevention of public nuisance
- Protection of children from harm
- Public safety

Please detail your objection(s) as fully as possible in the box below. If you do not then the Committee may not understand why you have objected.

Please attach supporting documents/further pages as necessary and number all extra pages.

Try to be as specific as possible and give examples e.g. *On 1 February I could hear loud music from the premises between 10pm and 1 am. I am concerned that if the premises open until 2 am this will cause a nuisance to me and other residents of the street.*

I/We have already made a written representation and have no further comments

See attached.

I am aware that a full copy of my representation (including my name and address) will be sent to the applicant and will form part of a public document prior to any hearing on this matter.

Signed

Ann Welflow

Date

November 10th, 2010

Contact telephone number(s)

(This is essential as we may need to contact you at short notice)

16 Richmond Place
Lansdown
Bath BA1 5PZ
November 9th, 2010

Bath and North-East Somerset
District Council Licensing Authority
9-10 Bath St
Bath BA1 1SN

**Interested Party Representation
Licensing Act 2003
Re Application No. 10/03751/LAPRE**

Dear Sirs,

With regard to the application from The Richmond Arms Public House for the grant of a new Premises License, I have the following representation to make:

New first floor function area, with additional opening hours throughout, would mean effectively a leaving time approaching midnight during normal days, and around 1 am on bank holidays.

There is already very limited parking on Richmond Place, and additional attendance at functions will create even further disturbance and disruption for the residents neighbouring the public house. Furthermore, as the function room request is for all the opening hours, there could be even further disturbance when the school children and their parents are trying to gain access and egress from the school, particularly between 3pm and 4pm. Even more traffic problems would ensue. Parents and small children would find it even more difficult than at present.

The probability of live or recorded music at any time of the day between opening and closing hours is also very worrying, especially because of the request for longer opening hours.

My objection to these proposals is mainly that of increased public nuisance by way of loud noise, music and people leaving the area up until midnight or 1 am on Bank holidays. There could also be severe additional public nuisance from the function room (as stated above) should it be used during the day time, as well as the evening.

The Richmond Arms has always been part of Richmond Place, but this is a residential area, with families of all ages, including young children and very elderly people. Whilst appreciating the problems in making a going concern of a public house in the current climate, a function room plus extended hours is a step too far. Additional noise, customers and increased parking problems would seriously affect our day to day lives, and would adversely affect the way in which I wish to live. Clearly the priorities of a public house owner are different from mine and this application for potential serious interference with my quality of life is unwelcome and unreasonable.

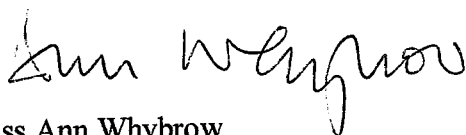

Miss Ann Whybrow

ANNEX E
CONTENTS

1. Introduction

2. Objectives

3. Scope

4. Methodology

5. Results

6. Discussion

7. Conclusions

8. Recommendations

9. References

10. Appendix



BATH & NORTH EAST SOMERSET

LICENSING ACT 2003

INTERESTED PARTY REPRESENTATION

ENVIRONMENTAL SERVICES

18 NOV 2013

Post Leg No. D/AB 215390

Receipt No.

CH/CA £

Please read the notes at the back of this form prior to completing it.

I/We object to the following application:

Application number:	10/03751/LAPRE
Applicant's name:	SYLVIA MIZEL
Premises name and address:	THE RICHMOND ARMS 7 RICHMOND PLACE BATH BA1 5PZ
Application for a:	NEW PREMISES LICENCE

Objector Details:

Objector's Name:	MRS. E. J. WOODHEAD
Objector's Address: This is essential because a representation can only be considered relevant if you live, or are representing an address, in the vicinity of the premises.	8 RICHMOND PLACE BATH BA1 5PZ
Organisation name if applicable:	—

Objection Details:

My/our representation is relevant to the following licensing objective(s):

Prevention of crime and disorder

Prevention of public nuisance

Protection of children from harm

Public safety



Please detail your objection(s) as fully as possible in the box below. If you do not then the Committee may not understand why you have objected.

Please attach supporting documents/further pages as necessary and number all extra pages.

Try to be as specific as possible and give examples e.g. On 1 February I could hear loud music from the premises between 10pm and 1 am. I am concerned that if the premises open until 2 am this will cause a nuisance to me and other residents of the street.

I/We have already made a written representation and have no further comments

Objections: Also see attached letter/photos

1. Size of pub doubled as a result of this 'first floor function room'.
2. Noise from said room which is right next to my bedroom.
3. Music from said room.
4. Concern about fire escape from room
5. Greater number of people leaving pub causing disturbance late at night.

I am aware that a full copy of my representation (including my name and address) will be sent to the applicant and will form part of a public document prior to any hearing on this matter.

Signed

Jane Woodhead

Date

17th November 2010

Contact telephone number(s)
(This is essential as we may need to contact you at short notice)

8 Richmond Place,
Bath BA1 5PZ
17th November 2010

Dear Emma Stoneman,

Application No. 10/03751/LAPRE

As an immediate neighbour of The Richmond Arms, I am concerned about the use of the first floor room as an extension of the dining area downstairs, which will double the number of diners, thus increasing the noise inside, and also outside when clients leave the premises. Noise carries at night, and the banging of car or taxi doors and loud talking would disturb the residents even more than it does already.

I am also concerned about music being played in this dining/function room, which is adjacent to my bedroom. I think that live music should only be played at the rear of the bar downstairs.

I enclose a photograph taken from my bedroom window and another from the pub gate, showing the close proximity of the proposed dining room to my window. I already have a problem with smokers standing outside the front door of the pub, especially in summer when my windows are open.

I also enclose a copy of the letter from the solicitors involved in a previous application for extension of licensing hours, in 2005, which lists the agreed points appertaining to the vacating of the garden, windows to be closed at that time etc. All these points should be diligently adhered to by the pub's staff.

This is after all a residential area, with a pub in the middle of a terrace of houses, and the quality of life for the residents of Richmond Place should be carefully considered.

Yours sincerely,

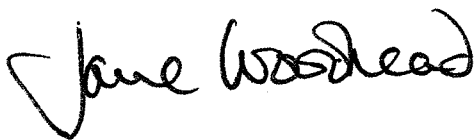

E.J. Woodhead

Encs.

2 photos
copy of letter from Marjorie Woodhead. 2005.

2

mowbraywoodwards

ANNEX E

Mrs E J Woodhead
8 Richmond Place
Lansdown
Bath
BA1 5PZ

Your Ref :
Our Ref : LW/CLC/S5588
Please ask for : Luke Watson
Direct Dial No. :
E-mail address : law@mowbraywoodwards.co.uk
Date : 16 September 2005

Dear Mrs Woodhead

RE: APPLICATION FOR CONVERSION AND VARIATION OF THE JUSTICES ON LICENCE IN RESPECT OF THE RICHMOND ARMS PUBLIC HOUSE WHICH WAS HEARD BEFORE THE LICENSING COMMITTEE AT BATH & NORTH EAST SOMERSET COUNCIL ON 7 SEPTEMBER 2005.

As you may be aware, I was instructed by Mr Michael and Mrs Patricia Symons with regard to their objection to the variation to the License being sought in respect of the Richmond Arms public house. You will no doubt also be aware that I instructed Mr James Brown, a Barrister from London, to attend at the hearing on behalf of Mr and Mrs Symons.

Many if not all of you will be aware of the outcome. However, Mr Symons has specifically requested that I write to each and every one of you with regard to the outcome of the hearing. In accordance with my clients' wishes, I will set out below the outcome of the hearing.

1. Service of alcohol; Monday to Thursday 11.00am to 11.00pm; Sunday 12noon to 11.00pm; Friday to Saturday 11.00am, to 1.00am.
2. Regulated entertainment; Monday to Saturday 11.00am to 11.00pm; Sunday 12noon to 10.30pm.
3. Opening hours; Monday to Thursday 11.00am to 11.30pm; Sunday 12noon to 11.30pm; Friday to Saturday 11.00am to 1.30am.
4. Bank holiday and public holiday exceptions are as before.

A condition was imposed that there would be regulated entertainment no more than 12 times per year.

A condition was imposed that the garden area must be vacated by 11.00pm Monday to Saturday and by 10.00pm on a Sunday.

A condition was imposed that there be no admission after 11.00pm Monday to Saturday and none after 10.00pm on Sundays.

A condition was imposed that the windows and doors are to be closed Monday to Saturday by 11.00pm and on Sunday by 10.00pm and also when regulated entertainment is taking place.

ii

ANNEX E

A condition was imposed that signs are to be erected encouraging patrons to leave quietly.

A condition was imposed that the Premises Supervisor is to monitor noise from outside when regulated entertainment is taking place.

Kind regards.

Yours sincerely

Luke Watson
MOWBRAY WOODWARDS

